



General catalogue 2020

Since 1945 superior quality products
for motorhomes, caravans,
van conversions and camper vans

Fiamma is known worldwide as a pioneer and leading company in manufacturing technical accessories for the recreational vehicle market.

INDEPENDENT FAMILY-OWNED COMPANY

Fiamma has more than 100 patents registered in Europe, USA, Japan and China. The headquarters in Cardano al Campo focuses on product design and worldwide distribution. In addition there are eight manufacturing facilities where product improvements, technology innovation and new production processes are constantly implemented. The Fiamma catalogue is translated into 11 languages including Chinese, Japanese and Russian.



Since 1996



Since 2002



Production monitored and safety tested



Fiamma: certified in environmental and climate protection



1945



Fiamma was founded by Norma and Arnaldo Pozzi. The name Fiamma, which in Italian means "flame" comes from the company's first product: an aluminium gas stove for camping.

Fiamma is the first company in Europe to introduce a complete range of superior quality products for Motorhomes and Trailers.



1973

1980



Fiamma starts its operation in the American market and becomes a leader in the production of awnings for Class B Motorhomes.

Fiamma creates the International Motorhome Club to strengthen the relationship between the company and its end-users. Fiamma becomes the first company in this market to get the TÜV-GS (German Quality Control) for its awnings.



1984

1987



Fiamma expands into the Japanese market to become the country's leading manufacturer of accessories for recreational vehicles.

Fiamma receives ISO 9002 certification.



1996

2002



Fiamma receives ISO 9001 certification for its new and state-of-the art factory located in Cardano al Campo.

Fiamma opens new departments equipped with high tech machinery, thereby increasing its production capacity by 40%.



2003

2005



Inauguration of Fiamma Service, the completely automated distribution center of spare parts.

John-David Pozzi (since 2008) and Charles Pozzi, grandsons of Norma and Arnaldo Pozzi, collaborate together in the function of Managing Directors of Fiamma Spa.



2012

2018



Thanks to competent and experienced technicians and through using modern state of the art testing equipment, Fiamma inaugurates the new laboratory and testing area.

Fiamma celebrates 75 years of activity.



2020

Tradition & Quality



FIAMMA.COM

On the Fiamma website you can find all updates and information on our products. In the “points of sale” section you can also find a list of the best Fiamma dealers.



COME AND VISIT US

The Fiamma stand is the meeting point for many motorhome fans in 52 international exhibitions of the RV industry. You can find the original Fiamma products in a selected network of motorhome specialists with extensive experience in the industry guaranteeing customer satisfaction.



RELIABLE QUALITY

Spare parts drawings for all Fiamma awnings, Carry-Bike and other Fiamma accessories are available online at www.fiamma.com. Our technical assistance team guarantees a prompt delivery of more than 10,000 spare parts. If you want to get the best quality and an excellent after-sales service, choose Fiamma products.



INNOVATION AND SAFETY

Fiamma has invested in cutting edge equipment and highly qualified staff to set up its excellent test laboratory in order to guarantee continuous growth in quality of the manufactured products. Before hitting the market, our new products are subjected to strict tests such as FEM analyses during the design phase using the most advanced aerospace software, along with raw materials testing, laser analysis, crash tests and many other specific tests and trials.

Index

Fiammastore

Awnings and Enclosures

Awnings

Winch awnings for wall installation.....	16-25
Winch awnings for roof installation.....	26-33
Manual awnings.....	34-39

Enclosures

Front and side panels.....	44-47
Enclosures for winch awnings.....	48-57
Enclosures for manual awnings.....	58-59
Complete tents (awning + enclosure).....	60-63
Rear door enclosure.....	64
Skirting.....	65

Accessories

Awning motor kits.....	66-67
Tension rafters.....	68-69
Pegs and anchoring straps.....	70-71
Awning mats.....	72
Miscellaneous.....	73-74
Enclosure & tent accessories.....	74-77
Rubber seals.....	77-79

Installation brackets

Adapters for F45 + F70.....	80-86
Adapters for F80 + F65.....	87-91
Adapters for F40van.....	92
Adapters for F35pro.....	93-95
Adapters for Compass.....	95
Adapters for CaravanStore.....	95

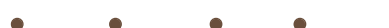
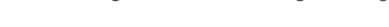

FIAMMA F45s PSA

p.19



new

CARRY-BIKE VW Caddy

p.118



new

CARRY-BIKE Ducato

p.125 / 126



new

Index

Carry-Bike

Bike carriers and accessories

For E-Bike 102-103

Motorhome



Pro Series 104-105

L Series 106-107

Lift Series 108-109

Special versions 110-111

Caravan



For A-frame 112-113

For rear wall 114-115

Campervan



For VW Transporter 116-119

For other camper vans 120-123

Van Conversion



For VW Crafter, Fiat Ducato & other van conversions... 124-127

SUV



For SUV, minivans and 4x4 128-129

Garage



Bike carriers for garage facility 130-131

Moto carriers for garage and van conversions 132-133

Accessories

Rails 134-137

Blocking systems 138-139

Straps, anti-theft systems & installation kits 140-141

Warning signals 142

Bike covers 143

Rear boxes 144-145

Drying racks 145

Deluxe ladders



Cargo Back



Pocket containers



Comfort

Other products for your comfort

Tech

Rooflights 148-155

LED lighting 156-161

Waterpumps 162-163

Plastic

Tanks 164-165

Levellers 166-171

Stabilising jacks 172

Portable steps 173

Organizers 174-176

Alu

Accessories for garage facility 177-180

Safety blocks 181-183

Security handles 184-185

Ladders 186-188

Roof boxes 189

Luggage carriers 190-191

Mix

Portable toilets 192-193

Sanitary line 194-195

Vehicle covers 196-197

Miscellaneous 198-199

Fiamma VW T5 and VW T6 program



F45s awnings for VW T5 and VW T6, 260 and 300cm lengths

18



F40van: the compact roof awning with lowered brackets, 270cm length

32-33



F35pro, the compact and sturdy awning with aluminium case and manual mechanism

36-37



Privacy Room Light: the light and compact Fiamma enclosure for your holidays on the move

52-53



Privacy Ultra Light, the one-piece enclosure, fresh and light, quick to assemble

54-55



Room Van, the all-round room for F40van awning

56-57



Fiamma specialises in VW T5 and T6 products: our complete range of products ensures a more comfortable vacation. Several awnings for every need, dedicated bike carriers and lots of accessories for increased comfort during your holidays



Compass, the manual awning with circular opening at 270°

38-39



Blocker & Side: front and side walls for sun and wind protection

44-47



Privacy Room, the classic enclosure to double your living space

48-50



Rear Door Cover VW T5 / T6: the awning for the rear door

64



Carry-Bike VW T5 & T6 Pro: modern design and quick assembly

116-117

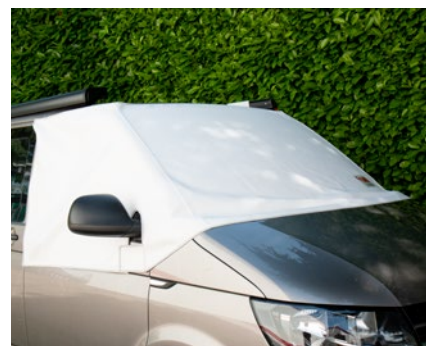

Coverglas: outside waterproof blind system to cover all the windows of the VW T6 cabin

197

Fiamma Fiat Ducato program



F45s: wall installation awning with specific brackets for Ducato vehicles

16-17
84



F80s: roof installation awning for Ducato van conversion, lengths from 290 to 450cm

26-27
90



F65eagle Ducato, the legless awning

30-31



Carry-Bike DJ designed for Ducato with double rear doors

125-127

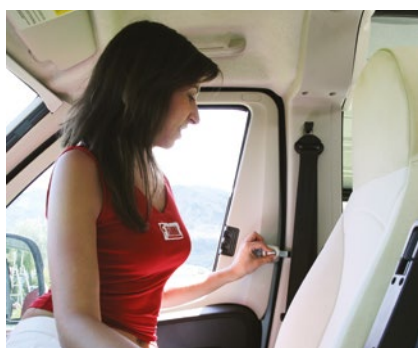

Security block designed to be placed on the inside of the door

181



Deluxe: aluminium ladders supplied with Fixing Bars for easy and quick installation

186-187



Many interesting accessories for your Fiat Ducato, Citroën Jumper or Peugeot Boxer: awnings with dedicated brackets, bike carriers, luggage racks, covers and other accessories for a comfortable and relaxing vacation



Privacy Room: enclosure for Ducato with additional panels for the different lengths

48-51



Privacy Ultra Light, the cool and ultra light enclosure that can be assembled in just a moment

54-55



Rear Door Cover Ducato: the enclosure for rear door

64



Roof Rail, luggage carrier system. Easy installation without drilling the vehicle

190-191



Different solutions to completely protect the engine compartment

197



Roller Roof Rail: helps loading objects from the rear of the vehicle

190-191



Carry-Bike



Motorhome

Pro Series	104-105
L Series	105-107
Lift Series	108-109
Special versions	110-111

Caravan

For A-frame	112-113
For rear wall	114-115

Campervan

For VW	116-119
For other camper vans	120-123

Van conversion

For Crafter, Ducato and other van conversions	124-127
---	---------

SUV

For SUV, minivans and 4x4	128-129
-------------------------------------	---------

Garage

Bike carrier for garage facility	130-131
Moto carrier for garage and van conversions	132-133

Accessories

Rails	134-137
Blocking systems (Bike-Block)	138-139
Straps, anti-theft systems & installation kits	140-141
Warning signals	142
Bike covers	143
Rear boxes	144-145
Drying racks	145

CARRY-BIKE

Fiamma Carry-Bike: the original bike carrier!

Fiamma bike carriers are manufactured in our factory in Cardano al Campo, Italy, made with state of the art technology.

Quality



Fiamma Carry-Bikes use the highest quality anodized aluminium rounded tubes. For even greater resistance and capacity, several Fiamma Carry-Bike models use an improved, extendable rounded frame. Fiamma Carry-Bikes are manufactured using only long life stainless steel screws and have the double reinforced bike carrier rail and the safety strap Quick-Safe. Some models are equipped with the innovative and exclusive Rail Premium.

Safety



All Fiamma Carry-Bikes are rigorously tested in our laboratories before being released into the market, in order to grant the greatest security. Fiamma Carry-Bikes have passed many reliability and security tests, for this reason they are preferred by many OEM manufacturers who preinstall them on the walls of their vehicles.

Innovation



E-BIKES

Fiamma offer 6 models dedicated to E-Bike transport: Pro, Pro C and Lift 77 (with lowering support rail with a drop of 77cm) for Motorhome, the Mercedes V Class Lift for Campervan and XLA Pro 200 and Caravan Active (both for A Frame installation) for Caravan.

Please contact your local dealer to see if your Electric Bikes are suitable, and that they do not exceed the maximum permitted weight.

We suggest that the installation is carried out by a dealer.

Fiamma recommends to use only the special versions of Carry-Bike for E-Bike if you want to transport electric bicycles.

Bike carrier solutions for any RV

No matter what the vehicle is, in our wide range of Carry-Bikes you will find the right model!

Motorhome



- Installation to the rear wall
- Specific models are available for E-Bike as well

Caravan



- Installation on the A-frame or to the rear wall
- Specific models are available for E-Bike as well

Campervan



- Specific models for the most common vehicles
- Specific models are available for E-Bike as well

Van Conversion



- Specific models for the most common vehicles with single and double rear door

SUV / 4x4



- Models with installation to the rear door or the rear spare tyre





[1] ZOOM 4 BIKES

ZOOM-4 BIKES is the telescopic rail support with a thicker rounded tube, reinforced elements in stainless steel and aluminium allowing to fit up to 4 bikes.

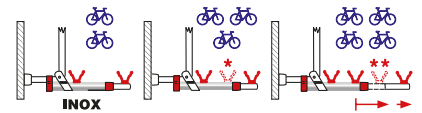

[2] BIKE-BLOCK

Bike-Block Pro and Pro S, which are delivered as standard with the majority of Carry-Bikes, are anti-scratch, safe and easy to use fixing kit for bicycles. Perfect for all tubes with diameter from 25 to 100mm.



[3] BULL SHOCK ABSORBER

Bull Shock Absorber is the best and most reliable system for shock and vibration absorption during travel.



[4] EASY POSITION

Easy position is the system to offset the rails of the bike carrier in order to simplify the transport of multiple bikes at the same time. All rails are mechanically fixed by means of rust free stainless steel screws to avoid movement.

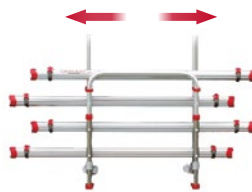

[5] RAIL PREMIUM / RAIL QUICK PRO / RAIL STRIP PRO

Different styles of rails to suit the different Carry Bike models. All versions have recently been renewed, giving a modern design and a more practical use. Solidity and performance guaranteed over time.



[6] QUICK LOCK

Quick-Safe is the safety strap to safely mount and lock the wheels on the bike carrier rail. Easy release for immediate opening.



[7] RACK HOLDER

It's a locking system which hold the racks of the carrier closed while it is not in use.



	Page	Item No.	Description	For E-Bike	Max load	Carry-Bike Weight	Bikes standard
Motorhome	105	02094-09A	Carry-Bike PRO		60 kg	8,4 kg	2
	105	02094-11A	Carry-Bike PRO M		60 kg	8,5 kg	2
	105	02094-10A	Carry-Bike PRO C		60 kg	7,9 kg	2
	102/105	02094B12A	Carry-Bike PRO E-Bike	●	60 kg	10,4 kg	2
	102/105	02094B13A	Carry-Bike PRO C E-Bike	●	60 kg	9,9 kg	2
	107	02093B86A	Carry-Bike UL		55 kg	5,6 kg	2
	107	02094A04A	Carry-Bike UL 48		55 kg	5,6 kg	2
	107	02093B87A	Carry-Bike CL		35 kg	5,4 kg	2
	109	02093F43A	Carry-Bike LIFT 77 [renewed]		60 kg	18,3 kg	2
	102/109	02093E43A	Carry-Bike LIFT 77 E-Bike	●	60 kg	16,3 kg	2
	111	02093A64B	Carry-Bike PRO Hymmer - Dethleffs [renewed]		60 kg	8,2 kg	2
	111	02093A98A	Carry-Bike Autotrail [renewed]		40 kg	12 kg	2
	111	02093B59A	Carry-Bike L80 [renewed]		60 kg	7,9 kg	2
	111	02093A29A	Carry-Bike PRO C Knaus - Eifelland [renewed]		60 kg	8,1 kg	2
	111	02093A57A	Carry-Bike Trigano - CI - Roller Team [renewed]		50 kg	5,2 kg	2
Caravan	113	02094-05A	Carry-Bike Caravan Active		60 kg	7,5 kg	2
	103/113	02094A06A	Carry-Bike Caravan Active E-Bike	●	50 kg	10 kg	2
	113	02094-23A	Carry-Bike Caravan XL A [renewed]		35 kg	5,3 kg	2
	113	02093B91A	Carry-Bike Caravan XL A Pro [renewed]		50 kg	9 kg	2
	113	02093F32A	Carry-Bike Caravan XL A Pro 200 [renewed]		50 kg	7,5 kg	2
	103/113	02093E32A	Carry-Bike Caravan XL A Pro 200 E-Bike	●	60 kg	10 kg	2
	115	02093A77A	Carry-Bike Caravan Hobby [renewed]		50 kg	5,6 kg	2
Campervan	115	02093A76A	Carry-Bike Caravan Universal [renewed]		35 kg	7,5 kg	2
	115	02093A36A	Carry-Bike Simple Plus 200 [renewed]		35 kg	6,4 kg	2
	117	02094B08A	Carry-Bike VW T6 Pro		60 kg	14 kg	2
	117	02094A08A	Carry-Bike VW T6 Pro - Deep Black		60 kg	14 kg	2
	117	02094-20A	Carry-Bike VW T6		60 kg	14 kg	2
	117	02093E71A	Carry-Bike VW T5 Pro		60 kg	14 kg	2
	117	02094-17A	Carry-Bike VW T5		60 kg	8,3 kg	2
	119	02094-24A	Carry-Bike VW Caddy [new]		60 kg	10,0 kg	2
	119	02093-18A	Carry-Bike VW T4		60 kg	8,3 kg	2
	119	02093B79A	Carry-Bike VW T5 / T6 D		35 kg	7,7 kg	2
	119	02094-22A	Carry-Bike VW T4 D		35 kg	7,7 kg	2
	119	02094-19A	Carry-Bike VW T3 - T25		50 kg	6,5 kg	2
	119	02093B63A	Carry-Bike VW T2		35 kg	7,0 kg	2
	121	02093B75A	Carry-Bike Mercedes Viano		50 kg	10,0 kg	2
	121	02093A05A	Carry-Bike Mercedes Vito		60 kg	8,7 kg	2
	121	02094B14A	Carry-Bike Mercedes V Class Premium		60 kg	12,5 kg	2
	103/121	02094A15A	Carry-Bike Mercedes V Class Lift E-Bike	●	60 kg	20,5 kg	2
	123	02093B72A	Carry-Bike Opel Vivaro - Renault Trafic		60 kg	8,7 kg	2
	Van conversion	123	02094B07A	Carry-Bike Ford Custom		50 kg	8,5 kg
123		02093A60A	Carry-Bike Ford Transit		50 kg	7,1 kg	2
123		02093B74A	Carry-Bike Renault Trafic D		35 kg	8,2 kg	2
124		02094-21A	Carry-Bike VW Crafter Frame		50 kg	21,0 kg	2
125		02094-25A	Carry-Bike Ducato Frame - dal 2006 [new]		50 kg	21,0 kg	2
125		02094A25A	Carry-Bike Ducato Frame - dal 2006 - Deep Black [new]		50 kg	21,0 kg	2
127		02094-26A	Carry-Bike 200 DJ Ducato - dal 2006 [renewed]		35 kg	11,0 kg	2
127		02094A26A	Carry-Bike 200 DJ Ducato - dal 2006 - Deep Black [renewed]		35 kg	11,0 kg	2
SUV	127	02093A65A	Carry-Bike 200 DJ Ducato - fino al 2006		35 kg	9,0 kg	2
	127	02093B93A	Carry-Bike 200 DJ Sprinter - dal 2006		35 kg	9,0 kg	2
Garagen	127	02093A15A	Carry-Bike 200 D		35 kg	6,9 kg	2
	129	02093A38-	Carry-Bike Backpack		50 kg	8,0 kg	2
	129	02093B38-	Carry-Bike Backpack 4x4		35 kg	7,8 kg	2
	131	02093A78A	Garage Plus [renewed]		60 kg	5,6 kg	2
	131	02093A54A	Garage Standard [renewed]		50 kg	4,8 kg	2
	131	04822-05-	Carry-Bike Garage Slide Pro Bike		50 kg	9,9 kg	2
	133	02095-03-	Carry-Moto Pro		200 kg	15,4 kg	-
	133	02095-01-	Carry-Moto		200 kg	12,2 kg	-
	133	02095-04-	Carry-Ramp		130 kg	7 kg	-

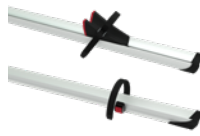

Bikes max	Strip	Bike-Block	Model of rail delivered as standard	Zoom 4 Bikes	Easy Position	Bull Shock Absorber	Quick Lock	Rack Holder
4	-	Pro 1 - Pro 3	Quick Pro	●	●	●	●	2
4	-	Pro 1 - Pro 3	Quick Pro	●	●	●	●	2
4	-	Pro 1 - Pro 3	Quick Pro	●	●	●	●	2
2	-	Pro S 1 - Pro S 2	Premium		●	●	●	2
2	-	Pro S 1 - Pro S 2	Premium		●	●	●	2
3	1	Pro 3	Quick Pro		●		●	2
3	1	Pro 3	Quick Pro		●		●	2
2	1	Pro 2	Quick Pro		●		●	2
4	-	Pro 1 - Pro 3	Quick Pro	●	●	●	●	2
2	-	Pro S 1 - Pro S D1	Premium		●	●	●	2
4	-	Pro 1 - Pro 3	Quick Pro	●	●	●	●	2
2	-	Pro 2 - Pro 3	Quick Pro		●	●	●	2
4	-	Pro 1 - Pro 3	Quick Pro	●	●	●	●	2
4	-	Pro 1 - Pro 3	Quick Pro	●	●	●	●	2
3	1	Pro 3	Quick Pro		●		●	1
3	-	Pro S 3	Quick Pro				●	-
2	1	Pro S 2	Premium				●	-
2	2	-	Quick Pro				●	-
3	1	Pro 3	Quick Pro				●	-
2	1	Pro 2	Quick Pro				●	-
2	1	Pro 1 - Pro D 1	Premium				●	-
3	1	Pro 3	Quick Pro		●		●	1
2	-	Pro 1 - Pro 2	Quick Pro		●		●	1
2	-	Pro 1 - Pro 2	Quick Pro		●		●	1
4	1	Pro S D1 - Pro S D2	Premium	●	●	●	●	2
4	1	Pro S D1 - Pro S D2	Premium	●	●	●	●	2
4	1	Pro 1 - Pro D2	Quick Pro	●	●	●	●	2
4	1	Pro S D1 - Pro S D2	Premium	●	●	●	●	2
4	-	Pro 1 - Pro D2	Quick Pro	●	●	●	●	2
4	-	Pro 1 - Pro 3	Quick Pro					2
4	-	Pro 1 - Pro 3	Quick Pro	●	●	●	●	2
2	-	Pro S 1 - Pro S 2	Premium		●		●	1
2	-	Pro 1 - Pro 2	Premium		●		●	1
3	-	Pro 1 - Pro 3	Quick Pro		●		●	1
2	-	Pro 1 - Pro 2	Quick Pro		●		●	-
3	-	Pro S 1 - Pro S 3	Quick Pro		●		●	1
4	-	Pro 1 - Pro 3	Quick Pro	●	●	●	●	2
4	-	Pro S 1 - Pro S 3	Premium	●	●	●	●	2
2	-	Pro S D1 - Pro S 1	Premium			●	●	2
4	-	Pro S 1 - Pro S 3	Quick Pro	●	●	●	●	2
3	-	Pro S 1 - Pro S 3	Quick Pro		●		●	2
3	-	Pro 1 - Pro 3	Quick Pro		●		●	1
2	-	Pro 1 - Pro 2	Premium		●		●	-
3	-	Pro 1 - Pro 3	Quick Pro				●	2
3	-	Pro S D1 - Pro S D1	Quick Pro					
3	-	Pro S D1 - Pro S D1	Quick Pro					
2	-	Pro S D1 - Pro S D1	Quick Pro		●		●	2
2	-	Pro S D1 - Pro S D1	Quick Pro		●		●	2
2	-	Pro 1 - Pro 2	Premium		●		●	1
2	-	Pro S 1 - Pro S 2	Premium		●		●	1
2	-	Pro 1 - Pro 2	Premium		●		●	1
3	-	Pro 1 - Pro 3	Quick Pro		●		●	-
2	-	Pro 1 - Pro 2	Strip Pro		●		●	-
4	-	Pro 1 - Pro 3	Quick Pro	●	●		●	-
3	-	Pro 1 - Pro 3	Strip C		●			-
2	2	-	-				●	-
-	-	-	-					-
-	-	-	-					-
-	-	-	-					-

From motorhomes to caravans and minivans. All Carry-Bike models dedicated to the transport of electric bicycles

PRO E-BIKE



The telescopic bike carrier, leader of Pro line, here in the special version for E-Bikes. Has a highly adjustable upper structure for better stability. The rounded tube structure is easily adjustable from 80 to 150cm in height to fit different installation requirements.



PRO C E-BIKE



The Pro C E-Bike carrier can be installed under the rear window of the motorhome whilst still allowing it to open. It is the most compact on the market, and has an adjustable installation from 40 to 50cm.



LIFT 77 E-BIKE



The E-Bike carrier with pivoting rail support base, it lowers as much as 77cm enabling the E-bikes to be loaded and unloaded easily



Description	Pro E-Bike	Pro C E-Bike	Lift 77 E-Bike
Item No.	02094B12A	02094B13A	02093E43A
Vehicle type	motorhome	motorhome	motorhome
Vehicle rear window / rear door	-	window	-
TÜV	●	●	●
Weight	10,4 kg	9,9 kg	16,3 kg
Max load	60 kg	60 kg	60 kg
Bikes carried standard	2	2	2
Bikes carried max	2	2	2
Licence Plate Carrier			
Strip Red			
Bike-Block Pro 1			
Bike-Block Pro D1			
Bike-Block Pro S D1			●
Bike-Block Pro S 1	●	●	●
Bike-Block Pro S 2	●	●	
Security Strip	●	●	●
Rail Premium	● (x2)	● (x2)	● (x2)
Mini Rail Premium			
Brackets	●	●	●

● Standard ○ Optional



Fiamma recommends to use only the special versions of Carry-Bike for E-Bike if you want to transport electric bicycles

**CARAVAN
ACTIVE E-BIKE**



Special version specifically designed for the transportation of two electric bicycles. Thanks to the system with tensioning strap, access to the storage compartment is easy and quick.

**CARAVAN
XL A PRO 200 E-BIKE**



Model designed to be installed on the caravan A-frame for carrying two E-Bikes. Suitable for all A-frames.

**MERCEDES
V CLASS LIFT E-BIKE**



Model for Mercedes V Class with pivoting rail support base which can be lowered by 77cm to facilitate loading and unloading operations of two electric bicycles. It comes complete with number plate holder bar and lights.



Caravan Active E-Bike	Caravan XL A Pro 200 E-Bike	Mercedes V Class Lift E-Bike
02094A06A	02093E32A	02094A15A
caravan	caravan	campervan tailgate
-	-	●
10 kg	10 kg	20,5 kg
60 kg	50 kg	60 kg
2	2	2
2	2	2
●		●
	●	
	●	
		●
		●
●		
●	●	●
● (x2)	●	● (x2)
	●	
●	●	●

Rail Premium

All Fiamma bike carriers designed for electric bikes are delivered as standard with two Rail Premium. The updated rail without wheel locking handwheel (see page 134) ensures quick and safety fastening of electric bicycles.





CARRY-BIKE Pro Series

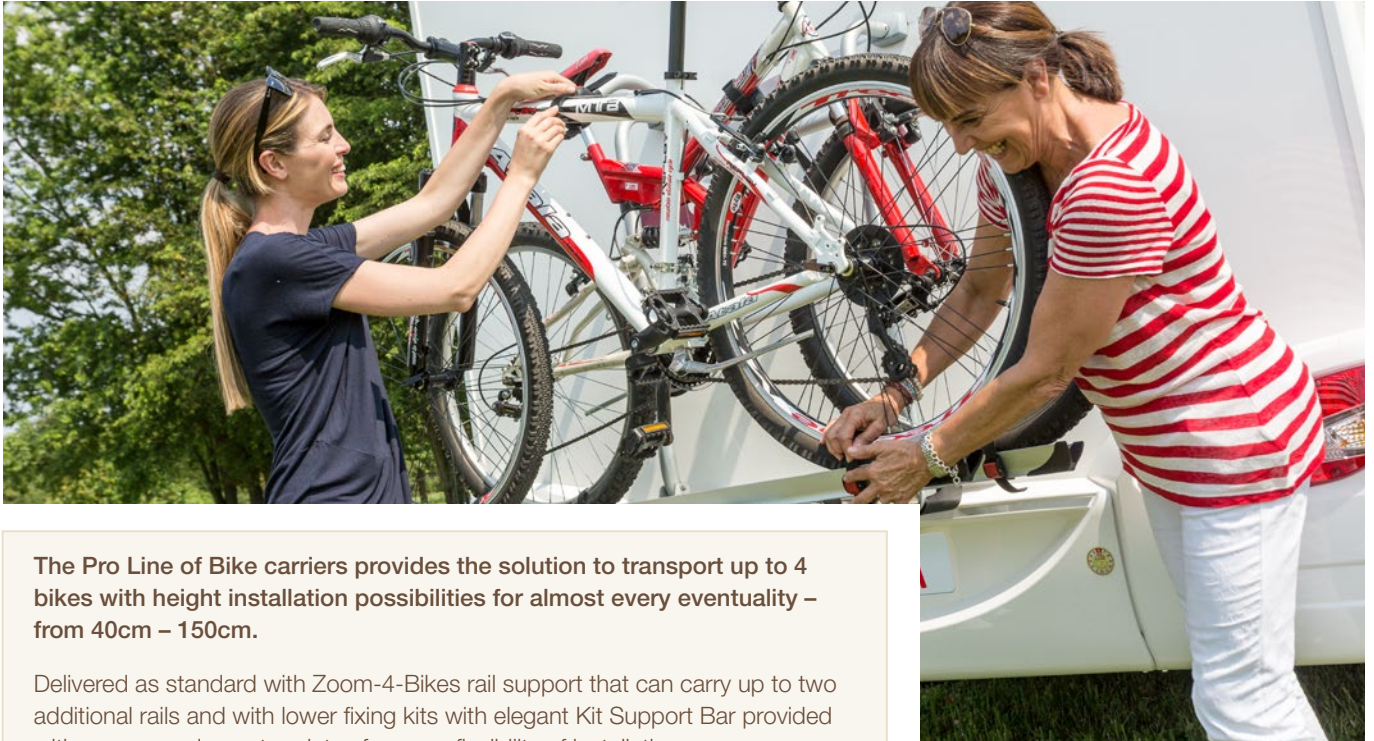

The Pro Line of Bike carriers provides the solution to transport up to 4 bikes with height installation possibilities for almost every eventuality – from 40cm – 150cm.

Delivered as standard with Zoom-4-Bikes rail support that can carry up to two additional rails and with lower fixing kits with elegant Kit Support Bar provided with screws and counter plates for more flexibility of installation. Also available versions suitable for E-Bikes.



PRO

This telescopic bike carrier, is the longest version of the Pro series, and has a highly adjustable upper structure for better stability. The rounded tube structure is easily adjustable from 80 to 150cm in height to fit different installation requirements.

PRO M

Intermediate version of Pro series with adjustable installation from 50 to 80cm, covering every requirement of installation with Pro and Pro C. Telescopic and adjustable structure.

PRO C

The compact and classic bike carrier, the shortest version of the Pro series which is installed under the rear window whilst still allowing it to open.

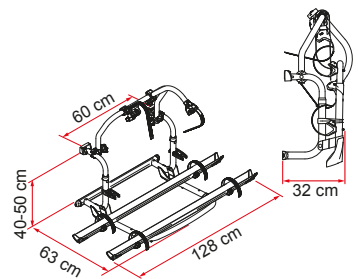
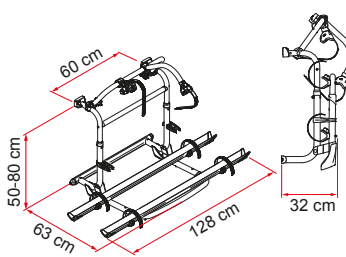
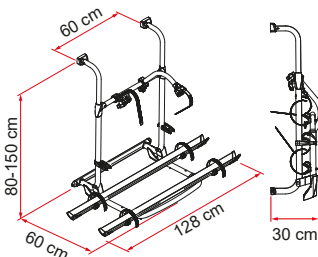



Choose the right model!!

This drawing helps you to easily find the Carry-Bike Pro most suitable for your vehicle.

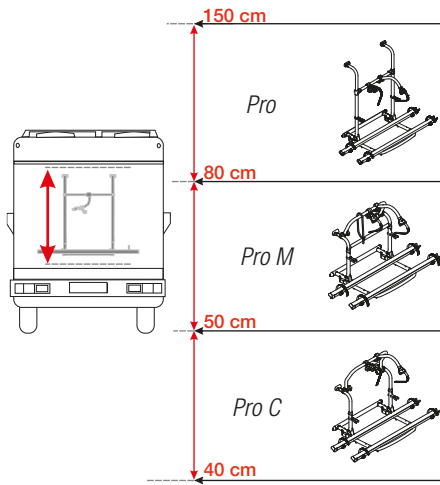

PRO E-BIKE

PRO C E-BIKE

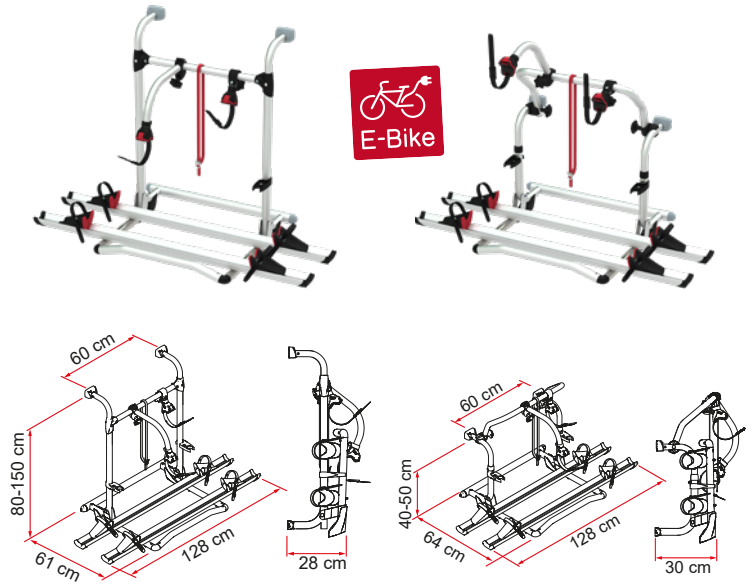

Kit Upgrade E-Bike

To carry your electric bicycles on your Carry-Bike Pro, Pro M or Pro C

Now you can turn your Carry-Bike Pro, Pro M, Pro C into a E-Bike bike carrier by purchasing the Kit Upgrade E-Bike (Item No. 98656M137). Complete rail support base with two Rail Premium, structurally designed to carry two electric bicycles.



Description	Pro • Pro N	Pro M • Pro M N	Pro C • Pro C N	Pro E-Bike	Pro C E-Bike
Item No. - black version (standard)	02094-09A (Pro) 02094-09V (Pro N) *	02094-11A (Pro M) 02094-11V (Pro M N) *	02094-10A (Pro C) 02094-10V (Pro C N)*	02094B12A	02094B13A
Item No. - blue version	02094-09B	02094-11B	02094-10B		
Vehicle type	motorhome	motorhome	motorhome	motorhome	motorhome
Vehicle rear window	-	-	●	-	●
TÜV	●	●	●	●	●
Weight	8,4 kg	8,5 kg	7,9 kg	10,4 kg	9,9 kg
Max load	60 kg	60 kg	60 kg	60 kg	60 kg
Bikes carried standard	2	2	2	2	2
Bikes carried max	4	4	4	2	2
Bike-Block Pro 1 (black)	●	●	●		
Bike-Block Pro 2 (black)	○	○	○		
Bike-Block Pro 3 (black)	●	●	●		
Bike-Block Pro 4 (black)	○	○	○		
Bike-Block Pro S 1				●	●
Bike-Block Pro S 2				●	●
Security Strip	●	●	●	●	●
Rail Quick Pro	● (x2) ○ (x2)	● (x2) ○ (x2)	● (x2) ○ (x2)		
Rail Premium S	○	○	○		
Rail Premium				● (x2)	● (x2)
Brackets*	included for Pro	included for Pro M	included for Pro C	included	included

* N version (Item No. 02094-09V, 02094-11V and 02094-10V) for vehicles with Fiamma original brackets pre-installed on it.
Ask your retailer for availability and delivery time of blue version.

● Standard ○ Optional



CARRY-BIKE L Series

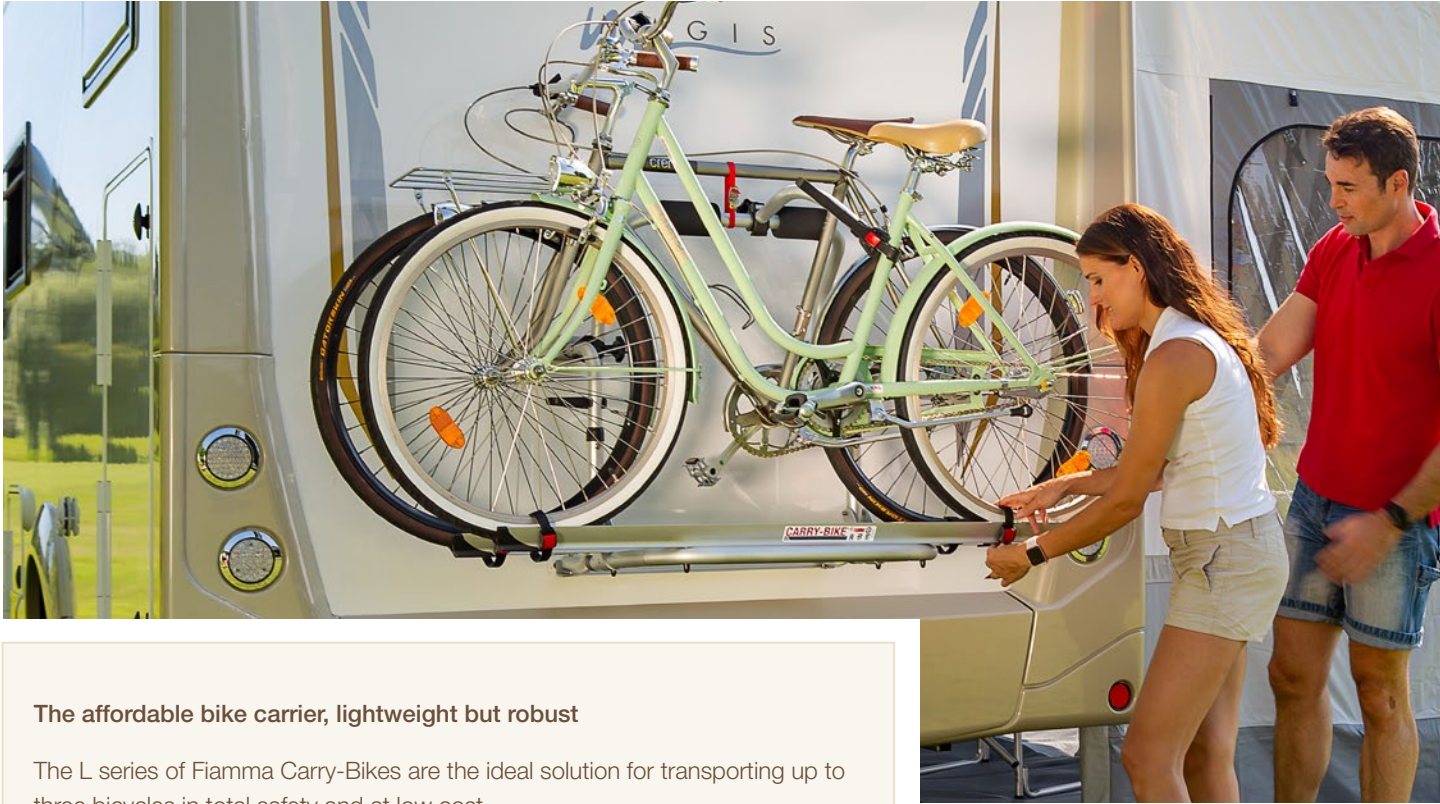

The affordable bike carrier, lightweight but robust

The L series of Fiamma Carry-Bikes are the ideal solution for transporting up to three bicycles in total safety and at low cost. A modern, reliable and aesthetically pleasing range.

UL

The classic and affordable bike carrier. Adjustable structure from 80 to 150cm in anodized aluminium.

UL 48

Similar to the UL model but with reduced projection, only 48cm. Comes with two rails, carries up to two bicycles.

CL

The strong, affordable and compact bike carrier. The solid yet light anodized aluminium structure is telescopic and adjustable from 40 to 50cm. It can also be installed under the motorhome rear window.

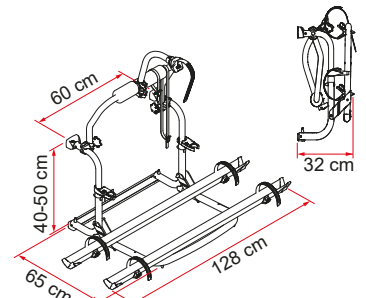
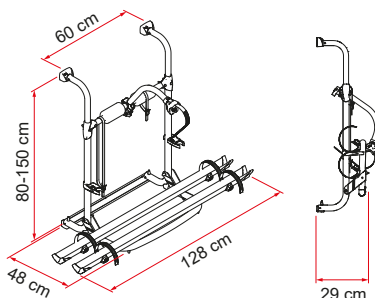
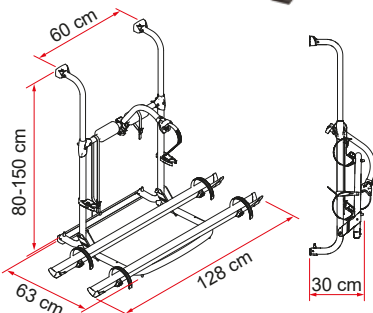



Choosing guide

Position

To be installed on the back wall of your motorhome. CL version is specially designed to fit below the rear window.

Capacity

Two bikes carried as standard, the models UL and CL can carry up to three bikes by adding an extra Rail and Bike-Block.

Rails

Two Rail Quick Pro delivered as standard which can carry any sort of bike and can also slide horizontally for easy positioning of the bikes.

Bike-Block

One Bike-Block Pro delivered as standard. Bike-Block Pro 2 optional for an extra bike (for models UL and CL).

Less weight, lower price and maximum reliability

Carry-Bike UL and CL have passed reliability and security tests, for this reason they are preferred by many OEM manufacturers who preinstall them on the walls of their vehicles.

Description	UL	UL 48	CL
Item No. - black version	02093B86A	02094A04A	02093B87A
Item No. - blue version	02093B86B		02093B87B
Item No. - grey version	02093B86G		02093B87G
Vehicle type	motorhome	motorhome	motorhome
Vehicle rear window	-	-	●
TÜV	●		●
Weight	5,6 kg	5,4 kg	5,6 kg
Max load	55 kg	35 kg	55 kg
Bikes carried standard	2	2	2
Bikes carried max	3	2	3
Strip Red	●	●	●
Bike-Block Pro 1 (black)	○	○	○
Bike-Block Pro 2 (black)	○	●	○
Bike-Block Pro 3 (black)	●		●
Security Strip	●	●	●
Rail Quick Pro	● (x2) ○ (x1)	● (x2)	● (x2) ○ (x1)
Rail Premium S	○	○	○
Brackets	●	●	●

● Standard

○ Optional



Ask your retailer for availability and delivery time of blue and grey versions



It lowers as much as 77cm enabling the bikes to be loaded and unloaded easily

It has a practical operating position and magnetic hooking to the handle for further operator ease of use. Crank handle can be shortened to suit every type of requirement. With its exclusive Zoom-4-bikes rail support, delivered with Extra-Large safety straps which carry up to 60 kg and safety system that avoids accidental unhooking en-route. Two versions available, for standard bikes and electrical bikes.



LIFT 77

LIFT 77 E-BIKE

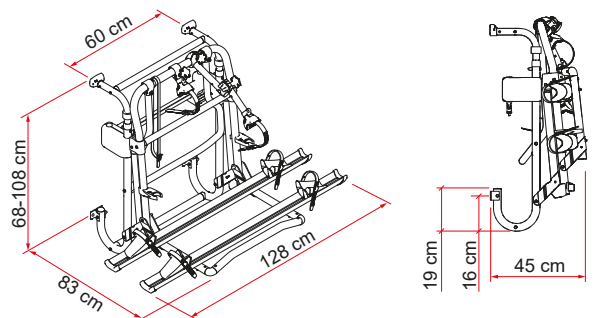
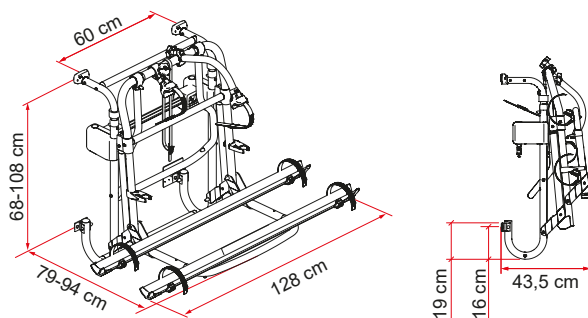
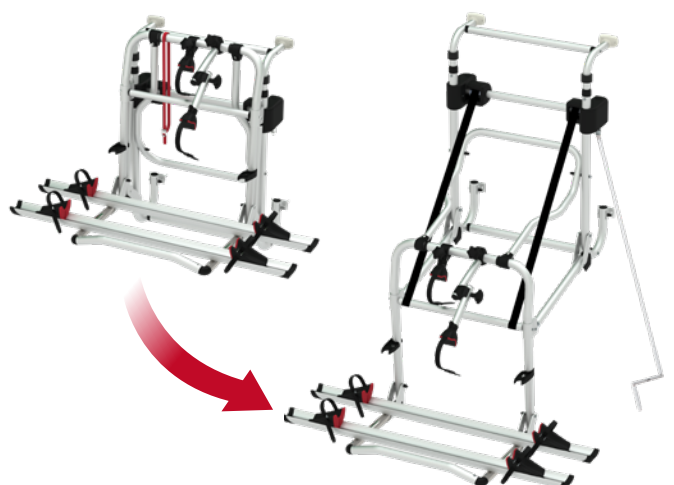
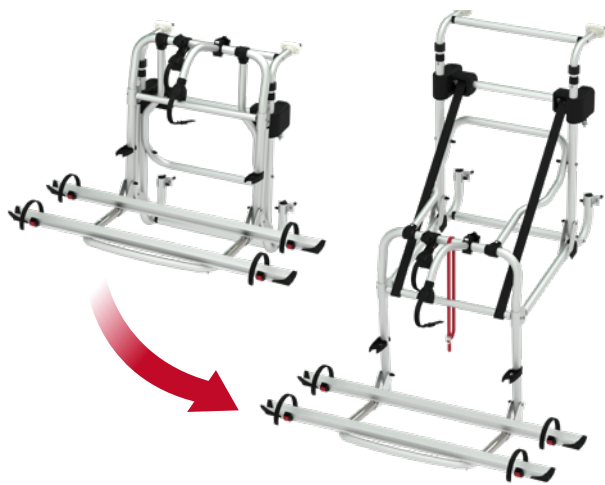



Choosing guide

Position

To be installed on the back wall of your motorhome. Wall fixing points range from 68 to 108cm.

Capacity

Two bikes carried as standard, the Lift 77 model carries up to 4 bikes with extra Rails and optional Bike Blocks.

Rails

Two Rail Quick/Premium delivered as standard which can carry any sort of bike and can also slide horizontally for easy positioning of the bikes.

Bike-Block Pro

Two Bike Block Pro/Pro S delivered as standard. For the Lift 77, Bike Blocks Pro 2 and Pro 4 are optional for extra bikes.

E-Bikes

The Carry-Bike Lift 77 E-Bike, together with the models Pro E-Bike and Pro C E-bike, are the ideal solution for transporting two electric bikes with a motorhome. It has been further strengthened to carry up to 60 kg in complete safety and with maximum ease of loading. Made of sturdy 35mm Ø anodised aluminium tubes and rail support base in stainless steel that guarantees absolute sturdiness. Perfect to lift 60 kg in complete safety. Maximum load per rail: 30 Kg.



Description	Lift 77	Lift 77 E-Bike
Item No.- black version	02093F43A [renewed]	02093E43A
Item No.- blue version	02093F43B [renewed]	
Vehicle type	motorhome	motorhome
Vehicle rear window	-	-
Weight	18,3 kg	16,3 kg
Max load	60 kg	60 kg
Bikes carried standard	2	2
Bikes carried max	4	2
Bike-Block Pro 1 (black) ø35	●	
Bike-Block Pro 2 (black)	○	
Bike-Block Pro 3 (black)	●	
Bike-Block Pro 4 (black)	○	
Bike-Block Pro S 1 ø35		●
Bike-Block Pro S D1		●
Security Strip	●	●
Rail Quick Pro	● (x2) ○ (x2)	
Rail Premium S	○	
Rail Premium		● (x2)
Brackets	●	●

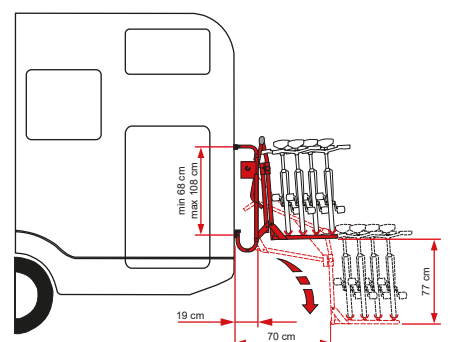

- Standard
- Optional



Special models

The special models of the Pro, Pro C and CL line, are developed for specific motorhomes allowing them to fit these vehicles perfectly. They have particular features that enable them to fit to many non-standard vehicles, at the same time allowing safe and easy installation.

PRO HYMER - DETHLEFFS

Carry-Bike Pro in blue version, suitable for Hymer motorhomes with preinstalled upper fixing brackets.

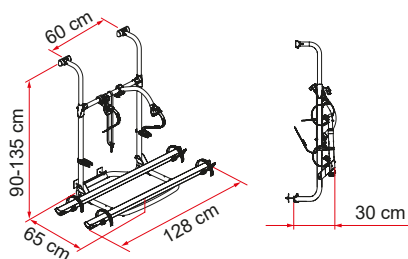

PRO AUTOTRAIL

Enlarged edition of Carry-Bike Pro for Autotrail motorhomes from 2011 to 2016 with integrated spare wheel moulding (rounded type).



KIT DETHLEFFS

For Dethleffs motorhomes, the upper brackets kit, adjustable to the standard installed brackets, is available on demand. To be used with Carry-Bike Pro Hymer-Dethleffs.

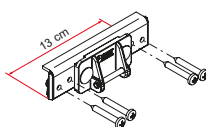

before 2010

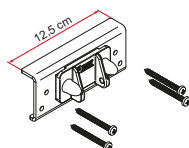

after 2010

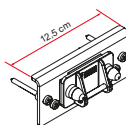

after 2016

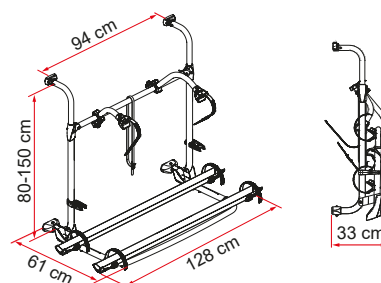

Description	Weight	Item No.
Kit Dethleffs < 2010	0,4 kg	98656-640
Kit Dethleffs > 2010	0,5 kg	98656-725
Kit Dethleffs > 2016 [new]	0,5 kg	98656M296



L80

This Carry-Bike is a Pro C version that has fixing points that are 80cm wide, suitable for Lakia motorhomes

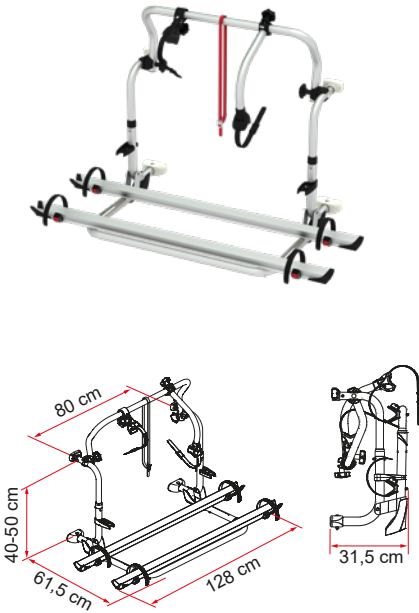

PRO C KNAUS - EIFELLAND

The upper structure holding the Bike-Blocks has been modified for Knaus campers and Eifelland caravans.

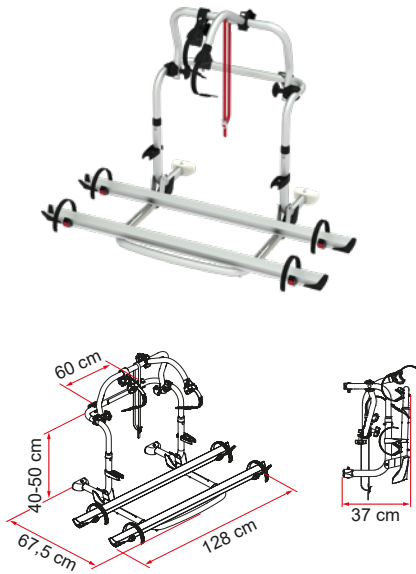

TRIGANO - CI - ROLLER TEAM

The bike carrier is provided with a fixed structure and height of 39.5cm (fixing points are 38.5cm top to bottom and 60cm wide). It comes without the upper and lower fixing kit, as these are already installed on the CI and Roller Team motorhomes.

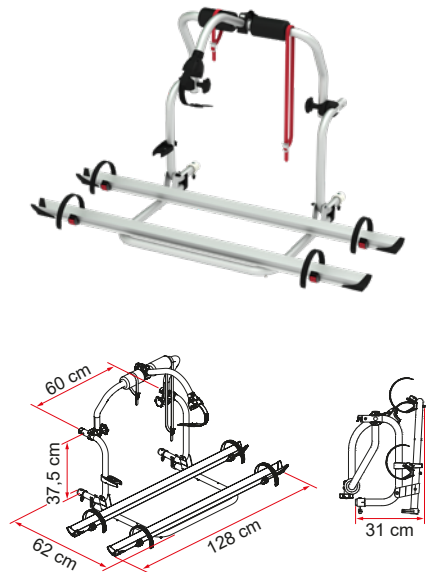

Description	Pro Hymer Dethleffs	Pro Autotrail	L80	Pro C Knaus - Eifelland	Trigano - CI Roller Team
Item No.	02093A64B (blue) [renewed]	02093A98A [renewed]	02093B59A [renewed]	02093A29A [renewed]	02093A57A [renewed]
Based on	Pro	Pro	Pro C	Pro C	CL
Vehicle type	motorhome	motorhome	motorhome	motorhome	motorhome
Vehicle rear window	-	●	●	●	●
TÜV	●				
Weight	8,2 kg	12 kg	7,9 kg	8,1 kg	5,2 kg
Max load	60 kg	40 kg	60 kg	60 kg	50 kg
Bikes carried standard	2	2	2	2	2
Bikes carried max	4	2	4	4	3
Strip Red					●
Bike-Block Pro 1 ((black))	● blue		●	●	○
Bike-Block Pro 2 (black)	○ blue	●	○	○	○
Bike-Block Pro 3 (black)	● blue	●	●	●	●
Bike-Block Pro 4 (black)	○ blue		○	○	
Security Strip	●	●	●	●	●
Rail Quick Pro	● blue (x2) ○ (x2)	● (x2)	● (x2) ○ (x2)	● (x2) ○ (x2)	● (x2) ○ (x1)
Rail Premium S	○	○	○	○	○
Brackets	●	●	●	●	

● Standard ○ Optional

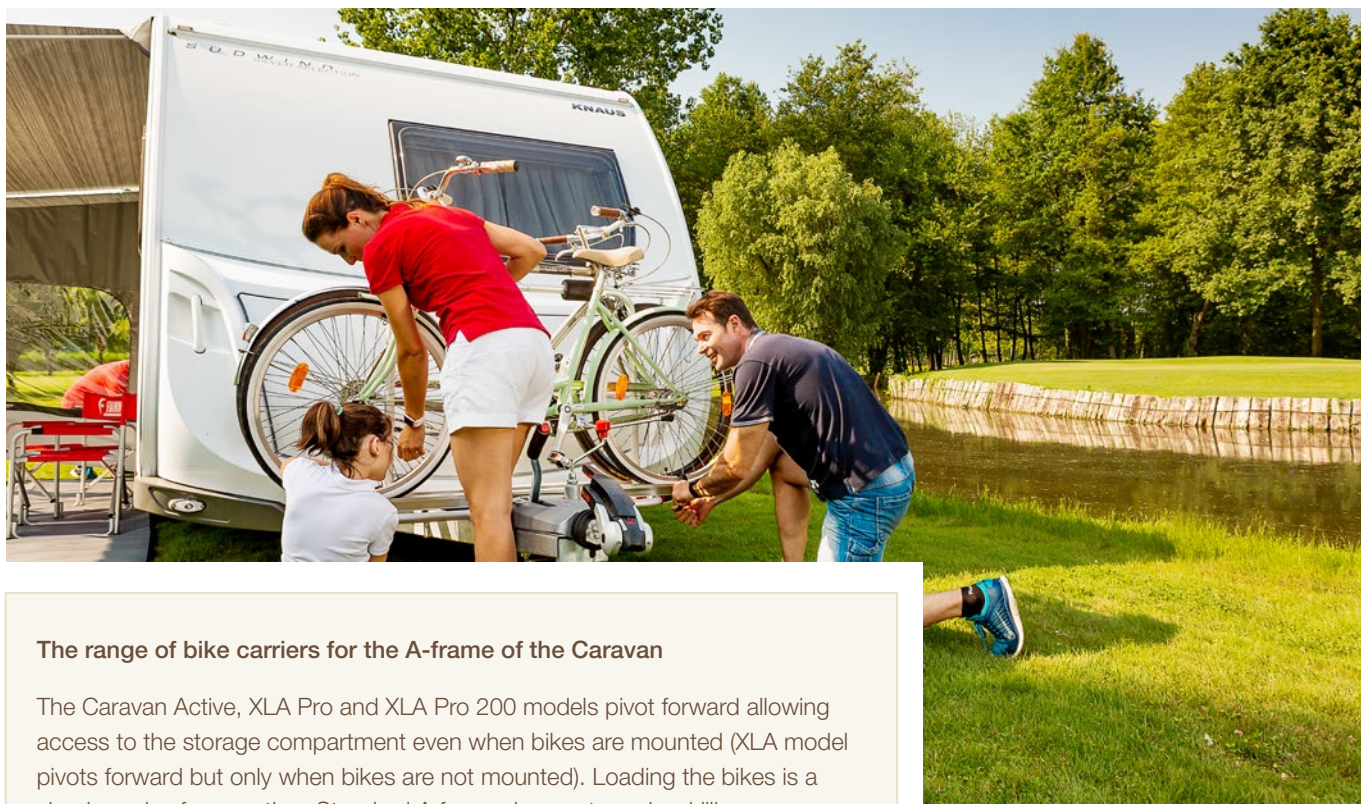

The range of bike carriers for the A-frame of the Caravan

The Caravan Active, XLA Pro and XLA Pro 200 models pivot forward allowing access to the storage compartment even when bikes are mounted (XLA model pivots forward but only when bikes are not mounted). Loading the bikes is a simple and safe operation. Standard A frame does not require drilling. Any plastic / fibre glass covers that cover the A frame need to be removed in order to fit the XLA range.



CARAVAN ACTIVE

The latest generation bike carrier for A frame. Thanks to the system with tensioning strap, access to the storage compartment is easy and quick.

CARAVAN ACTIVE E-BIKE

Special version of Caravan Active specifically designed for the transportation of two electric bicycles. It's equipped with Rail Premium for a maximum load of 30kg per rail.

CARAVAN XL A

Compact and inexpensive, fits almost all Caravan frames (including Hobby and Al-Ko).

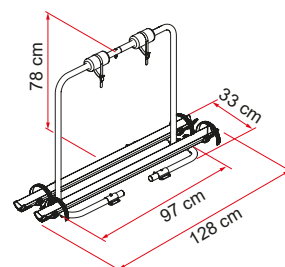
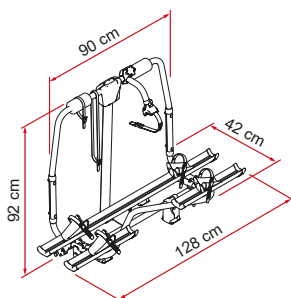
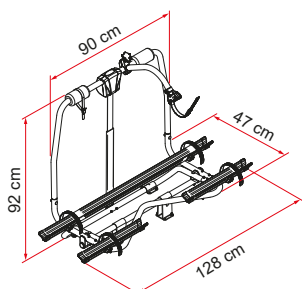



CARAVAN XL A PRO

Provided with reinforced bar, come as standard for two bikes, third optional rail can be added
Smaller size for short drawbars.

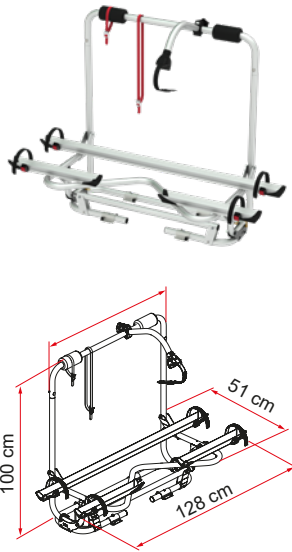

CARAVAN XL A PRO 200

Equipped with the external rail in two pieces to grant maximum possibility of installation and use.
Smaller size for short drawbars.

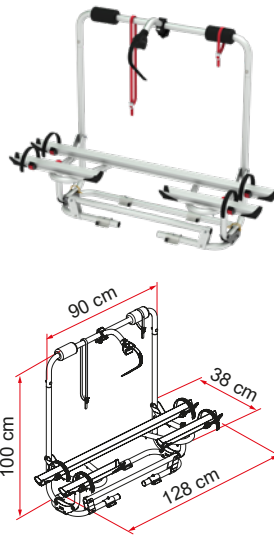

CARAVAN XL A PRO 200 E-BIKE

Special version specifically designed for the transport of two electric bicycles.
It fits all A-frame.
Reinforced structure for maximum safety.

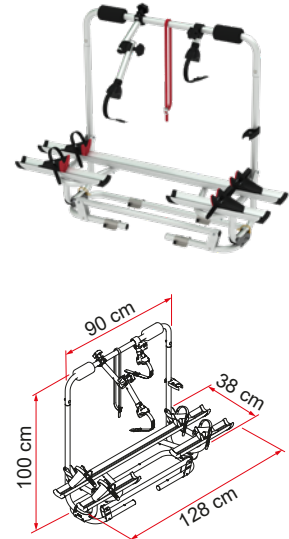

Description	Caravan Active	Caravan Active E-Bike	Caravan XL A	Caravan XL A Pro	Caravan XL A Pro 200	Caravan XL A Pro 200 E-Bike
Item No.- black version	02094-05A	02094A06A	02094-23A <i>[renewed]</i>	02093B91A <i>[renewed]</i>	02093F32A <i>[renewed]</i>	02093E32A
Item No.- blue version			02094-23B <i>[renewed]</i>	02093B91B <i>[renewed]</i>	02093F32B <i>[renewed]</i>	
Vehicle type	caravan	caravan	caravan	caravan	caravan	caravan
TÜV			●			
Weight	7,5 kg	10 kg	5,3 kg	9 kg	7,5 kg	10 kg
Max load	60 kg	60 kg	35 kg	50 kg	50 kg	50 kg
Bikes carried standard	2	2	2	2	2	2
Bikes carried max	3	2	2	3	2	2
A-frame: minimum size	315 mm	280 mm	402 mm	342 mm	342 mm	342 mm
Strip Red	●	●	● (x2)	●	●	
Bike-Block Pro 1 (black)						●
Bike-Block Pro 2 (black)				○	●	
Bike-Block Pro 3 (black)				●		
Bike-Block Pro D1 (black)						●
Bike-Block Pro S 2	○	●				
Bike-Block Pro S 3	●					
Security Strip	●	●	○	●	●	●
Rail Quick Pro	● (x2) ○ (x1)		● (x2)	● (x1) ○ (x1)	●	
Rail Premium (black)	○	● (x2)				
Mini Rail Quick				● (x1)	● (x1)	
Mini Rail Premium						● (x1)
Rail Premium						● (x1)
Brackets	●	●	●	●	●	●

● Standard ○ Optional



The complete range of bike carriers for the rear wall of the caravan

Bike carriers suitable for mounting on the rear wall of caravans. Three models developed to satisfy any need.



CARAVAN HOBBY

Suitable for mounting to the rear wall of Hobby Caravans, produced after 2003. The special upper brackets are positioned under the rail of the rear window. The lower fixing kit is a central bracket.

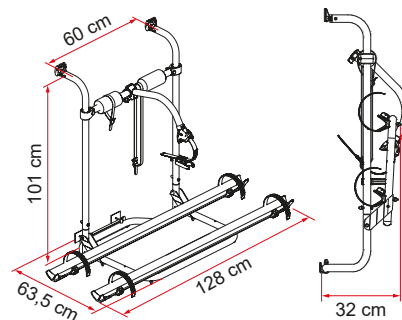

CARAVAN UNIVERSAL

Fixed to the caravan frame (Bürstner, Chateau etc.). Upper and lower brackets are installed by using self-tapping screws. Telescopic frame. Adjustable from 100 to 180 cm.

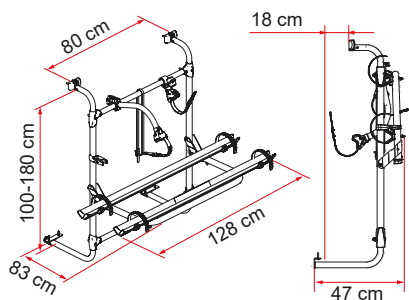



Choosing guide

Position

To be installed on the back wall of your caravan. Suitable for all types of caravan.

Capacity

The Caravan Hobby model carries two bikes as standard and has the possibility to add an extra Rail and Bike-Block for a third bike.
Max Load 35/50kg.

Rails

Two Rail Quick Pro delivered as standard which can carry any sort of bike and can also slide horizontally for easy positioning of the bikes.

Bike-Block Pro

Two Bike-Blocks Pro delivered as standard for models Universal and Simple Plus.
One Bike-Block Pro for the model Caravan Hobby.

SIMPLE PLUS 200

Suitable for mounting on caravans with thin and curved rear walls. Installed by using the existing wall reinforcement points. Telescopic frame.

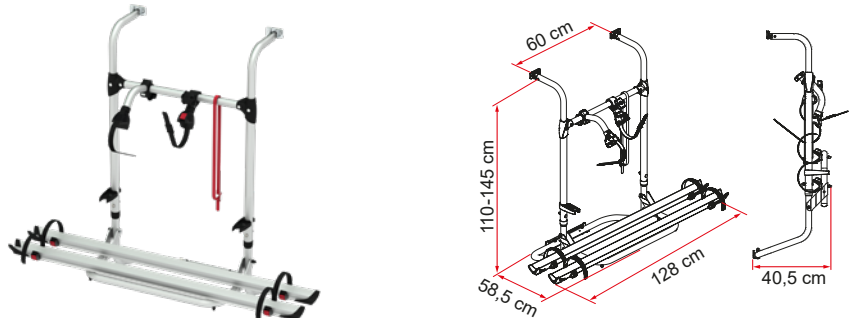

Description	Caravan Hobby	Caravan Universal	Simple Plus 200
Item No.	02093A77A [renewed]	02093A76A [renewed]	02093A36A [renewed]
Vehicle type	caravan	caravan	caravan
Weight	5,6 kg	7,5 kg	6,4 kg
Max load	50 kg	35 kg	35 kg
Bikes carried standard	2	2	2
Bikes carried max	3	2	2
Strip (black)	●		
Bike-Block Pro 1 (black)		●	●
Bike-Block Pro 2 (black)	○		●
Bike-Block Pro 3 (black)	● (blue)	●	
Security Strip	●	●	●
Rail Quick Pro	● (x2) ○	● (x2)	● (x2)
Rail Premium S	○	○	○
Brackets	●	●	●

● Standard ○ Optional



VW T5 PRO / VW T6 PRO: aesthetically modern, fast and simple to install, solid anchoring to the reinforced points of the rear of the vehicle



The stylish design harmoniously follows the line of the vehicle without covering lights and number plate. Simplicity and speed of installation / demounting and excellent rigidity on the rear of the vehicle. The upper brackets are fastened to the reinforced points of the rear of the vehicle, brackets are complete with plastic supports in the centre of them, free from any hooks the lower part of the vehicle does not lean against the bumper. Equipped with double lower reinforcing bar to ensure maximum stability. The shape of the rail support base [1], together with the optional rail split into two pieces [2], ensures excellent visibility of the central brake light, when four bikes are in use.



CARRY-BIKE VW T5 Pro / T6 Pro



CARRY-BIKE VW T6 Pro Deep Black

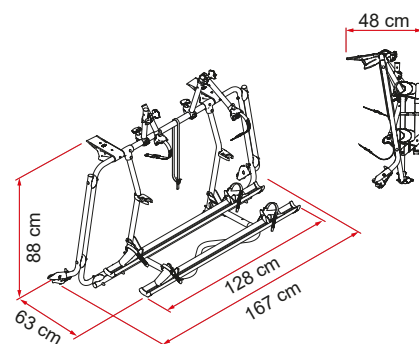

Deep Black version

Additional total black version for the Carry-Bike VW T6 Pro Deep Black that perfectly integrates the new body finish and the dark plastic parts.



1 *Rail support base*



2 *Fourth two-part rail*



Description	VW T5 PRO	VW T6 PRO	VW T5	VW T6
Item No.- black version	02093E71A	02094B08A	02094-17A	02094-20A
Item No.- Deep Black version		* 02094A08A		
Vehicle type	Minivan Volkswagen T5	Minivan Volkswagen T6	Minivan Volkswagen T5	Minivan Volkswagen T6
Weight	14 kg	14 kg	8,3 kg	8,3 kg
Max load	60 kg	60 kg	60 kg	60 kg
Bikes carried standard	2	2	2	2
Bikes carried max	4	4	4	4
Bike-Block Pro 1 (black)			●	●
Bike-Block Pro D1 (black)			○	○
Bike-Block Pro D2 (black)			● (x1) ○ (x1)	● (x1) ○ (x1)
Bike-Block Pro S D1	●	●		
Bike-Block Pro S D2	● (x1) ○ (x1)	● (x1) ○ (x1)		
Bike-Block Pro S D3	○	○		
Security Strip	●	●	●	●
Rail Quick Pro			● (x2) ○ (x2)	● (x2) ○ (x2)
Rail Premium S	○	○	○	○
Rail Premium	● (x2) ○ (x1)	● (x2) ○ (x1)		
Kit Rail Premium 48 (4° bike)	○ (x1)	○ (x1)		
Brackets	●	●	●	●

● Standard

○ Optional

* For Deep Black version choose Bike-Block and additional rail in Deep Black version, see page 137-138

VW T5 / T6

From 07/2003.

Bike carrier specially designed for Volkswagen T5 and T6 with single rear door.

Suitable for vehicles with raised roof too.

It can also be installed on the following vehicle models:

- VW California
- VW Multivan

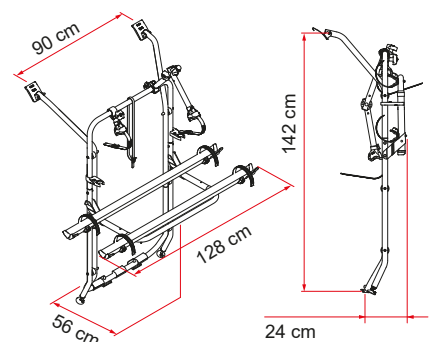

Now it's possible to convert the Carry-Bike T5 into a Carry-Bike T6

Have you changed vehicle and you want to reuse your bike-carrier VW T5 (Item No. 02093B71-) or VW T5 Pro (Item No. 02093C71-) on the new VW T6? Fiamma has thought of you with a cost-effective solution which allows this operation easily.

Kit Adapter T5 to T6



Kit Adapter T5 Pro to T6 Pro

Description	Weight	Item No.
Kit Adapter T5 to T6	0,7 kg	98656-988
Kit Adapter T5 Pro to T6 Pro	0,7 kg	98656M021



Carry-Bike minivan VW

Easy installation without drilling the vehicle

From VW Caddy to T2.

Fiamma offers a full range of bike carriers for every need.

For the new season Fiamma presents a specific bike carrier for Volkswagen Caddy campervan for the transport of four bikes.



VW CADDY

new

Bike carrier specially designed for VW Caddy > 2016. The articulated upper structure allows an accurate adjustment of the position of the Bike-Blocks to secure the bikes while the practical lower tensioning system allows the Carry-Bike to be safely fixed to the vehicle. The shaped brackets are attached to the reinforcement points of the tailgate. The solid anodized aluminium rail support base guarantees excellent resistance to strains/stress. Available from March 1st, 2020.

VW T4

After 1991.

Bike carrier specially designed for Volkswagen T4 with single rear door. It can also be installed on the following vehicle models:

- VW California
- VW Coach
- VW Caravelle
- VW Multivan

VW T5 D / T6 D

Bike carrier specially designed for Volkswagen T5 and T6 with double rear doors. Easy installation with brackets, that are delivered as standard, without drilling the vehicle.

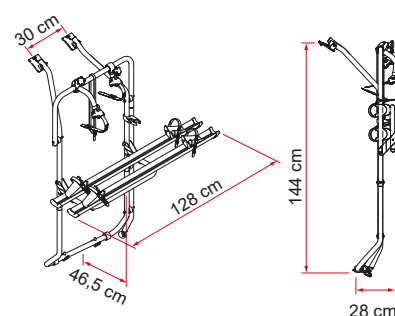
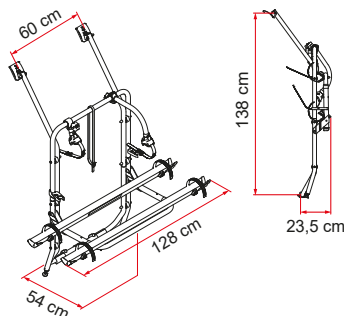
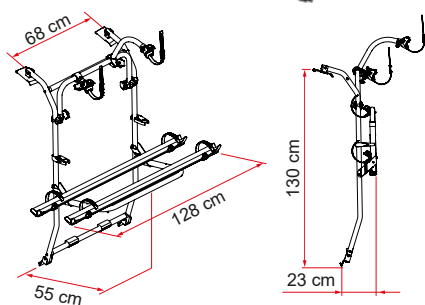



VW T4 D

Bike carrier specially designed for Volkswagen T4 with double rear doors. Easy installation with brackets, that are delivered as standard, without drilling the vehicle.



VW T3 (T25)

After 1980.



VW T2

Before 1980.

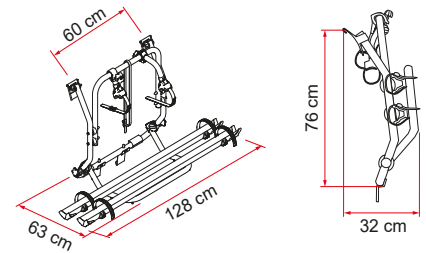
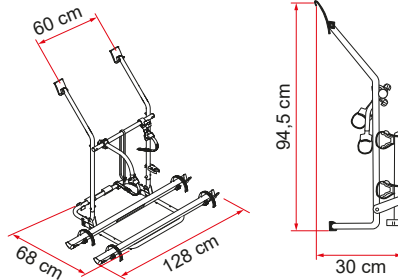
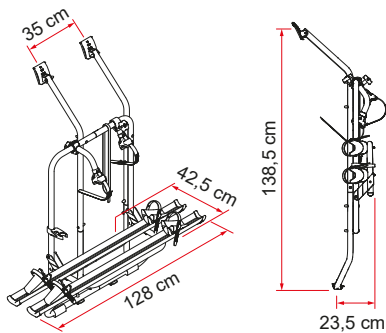

Description	VW CADDY >2016	VW T4	VW T5 D / T6 D	VW T4 D	VW T3 (T25)	VW T2
Item No.	02094-24A [new]	02094-18A	02093B79A	02094-22A	02094-19A	02093B63A
Vehicle type	Volkswagen campervan					
Rear door	tailgate	tailgate	double door	double door	tailgate	tailgate
TÜV		●				
Weight	10,0 kg	8,3 kg	7,7 kg	7,7 kg	6,5 kg	7,0 kg
Max load	60 kg	60 kg	35 kg	35 kg	50 kg	35 kg
Bikes carried standard	2	2	2	2	2	2
Bikes carried max	4	4	2	2	3	2
Bike-Block Pro 1 (black)	●	●		●	●	●
Bike-Block Pro 2 (black)	○	○		●	○	●
Bike-Block Pro 3 (black)	●	●			●	
Bike-Block Pro 4 (black)	○	○				
Bike-Block Pro S 1			●			
Bike-Block Pro S 2			●			
Security Strip	●	●	●	●	●	●
Rail Quick Pro	● (x2) ○ (x2)	● (x2) ○ (x2)			● (x2) ○ (x1)	● (x2)
Rail Premium			● (x2)	● (x2)		
Rail Premium S		○	○	○	○	○
Brackets	●	●	●	●	●	●

● Standard ○ Optional

CARRY-BIKE Mercedes

MERCEDES VIANO

For Mercedes Viano with single rear door, also suitable for Mercedes Vito from 2004 up to 2014.

Supplied with:

- 1x Carry-Bike Mercedes Viano
- 1x lighting board wired with 13 pin plug.

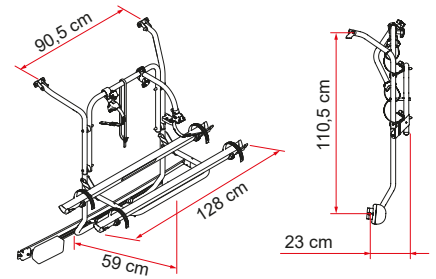

MERCEDES VITO

For Mercedes Vito with single rear door. Up to 2004.

On Mercedes Vito from 2004 install the model Mercedes Viano.

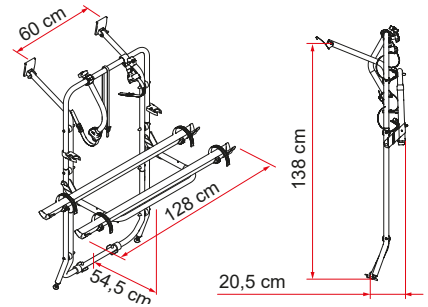

MERCEDES V CLASS PREMIUM

For easily transporting up to 4 bicycles on the Mercedes V Class with a single tailgate.

This version allows the installation of the rail support base in two different positions, one standard [A] and one lower [B] to make it easier to load the bikes.

Lower version must be used with the License Plate Carrier, which has the license plate holder bar and regulation lights [1].

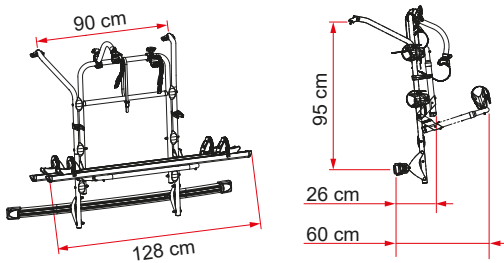

[A] Standard rail support base

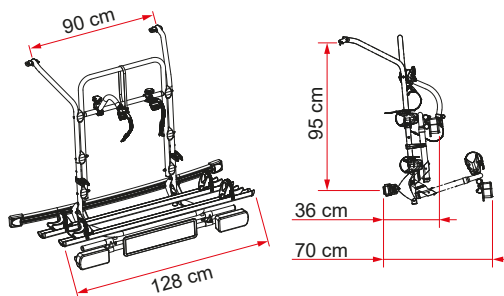

[B] Lower rail support base



Advantage:

The upper structure of the bike carrier is screwed to the vehicle chassis through the original vehicle mounting points [3], making it more stable and avoiding incorrect positioning problems during installation.



MERCEDES V CLASS LIFT E-BIKE



The support rail drops by 77cm [2] enabling the bikes to be loaded and unloaded easily. Delivered as standard with Licence Plate Carrier [1]. Suitable for transporting two E-Bikes.

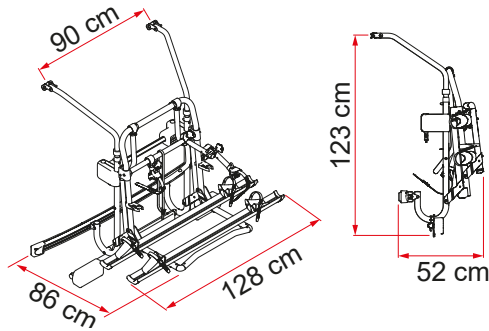

1 Licence Plate Carrier



2 Dropping support rail



3 Fixing without drilling

Description	Mercedes Viano	Mercedes Vito	Mercedes V Class Premium	Mercedes V Class Lift E-Bike
Item No.	02093B75A	02093A05A	02094B14A	02094A15A
Vehicle type	campervan	campervan	campervan	campervan
Rear door	tailgate	tailgate	tailgate	tailgate
Weight	10,0 kg	8,7 kg	12,5 kg	20,5 kg
TÜV			●	
Max load	50 kg	60 kg	60 kg	60 kg
Bikes carried standard	2	2	2	2
Bikes carried max	3	4	4	2
Licence Plate Carrier			○	●
Bike-Block Pro 1 (black)		●		
Bike-Block Pro 2 (black)		○		
Bike-Block Pro 3 (black)		●		
Bike-Block Pro 4 (black)		○		
Bike-Block Pro S D1			○	●
Bike-Block Pro S D2			○	
Bike-Block Pro S 1	●		●	●
Bike-Block Pro S 2	○		○	
Bike-Block Pro S 3	●		●	
Bike-Block Pro S 4			○	
Security Strip	●	●	●	●
Rail Quick Pro	● (x2) ○ (x1)	● (x2) ○ (x2)		
Rail Premium	○	○	● (x2) ○ (x2)	●
Rail Premium S	○	○		
Fixing-Bar			●	
Brackets	●	●		●

● Standard ○ Optional



FORD TRANSIT

Bike carrier suitable for all Ford Transit models from 2000 up to 2011 with single rear door.

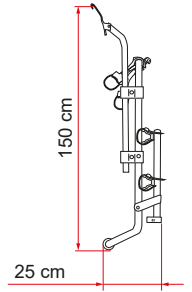
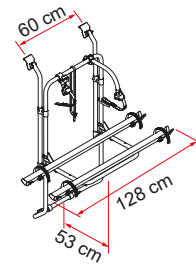

RENAULT TRAFIC D

For Renault Trafic D and Opel Vivaro with double rear doors. The upper bracket support point was recently modified in order to allow the view of the third stop (on version > 2015).

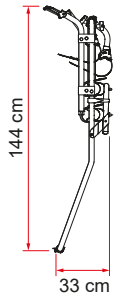
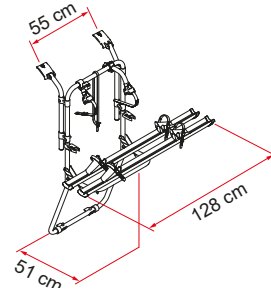

Description	Opel Vivaro - Renault Trafic	Ford Custom	Ford Transit	Renault Trafic D
Item No.	02093B72A	02094B07A	02093A60A	02093B74A
Vehicle type	campervan	campervan	campervan	campervan
Rear door	tailgate	tailgate	tailgate	double door
TÜV		●		
Weight	8,7 kg	8,5 kg	7,1 kg	8,2 kg
Max load	60 kg	50 kg	50 kg	35 kg
Bikes carried standard	2	2	2	2
Bikes carried max	4	3	3	2
Bike-Block Pro 1 (black)			●	●
Bike-Block Pro 2 (black)			○	●
Bike-Block Pro 3 (black)			●	
Bike-Block Pro S 1	●	●		
Bike-Block Pro S 2	○	○		
Bike-Block Pro S 3	●	●		
Bike-Block Pro S 4	○			
Security Strip	●	●	●	●
Rail Quick Pro	● (x2) ○ (x2)	● (x2) ○ (x1)	● (x2) ○ (x1)	
Rail Premium	○	○	○	● (x2)
Rail Premium S	○	○	○	○
Brackets	●	●	●	●

● Standard ○ Optional

CARRY-BIKE VW Crafter Frame



The only bicycle carrier for transporting three bicycles on a vehicle with double rear door

Here is the new specific Carry-Bike for VW Crafter / Man.

A solid steel frame is installed utilising the standard anchoring points **[1, 2 & 3]** on the vehicle.

It allows safe transport of up to three bikes and the rear double doors can also be opened when the bike carrier is installed. Not suitable for vehicles with 270° hinge system.



1 Safe Installation



2 Safe Installation



3 Safe Installation

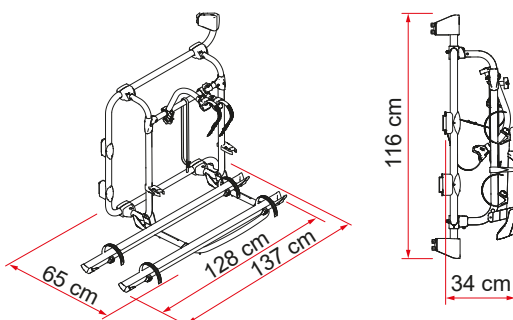

Description	CB VW Crafter > 2018
Item No.	02094-21A
Vehicle type	van conversion
Rear door	double door
Weight	16,0 kg
Max load	50 kg
Bikes carried standard	2
Bikes carried max	3
Bike-Block Pro 1 (black)	●
Bike-Block Pro 2 (black)	○
Bike-Block Pro 3 (black)	●
Security Strip	●
Rail Quick Pro	● (x2) ○ (x1)
Brackets	●

● Standard ○ Optional

CARRY-BIKE Ducato Frame

new



Carry-Bike Ducato Frame

The bike carrier that carries 3 bikes on the double rear door

Here is the new Carry-Bike Frame specific for Ducato >2006. The sturdy stainless steel frame [1] is installed using the attachment points present as standard [2 and 3] on the vehicle. This version allows the mounting of the rail support base in three positions, standard, intermediate and one lowered to facilitate the loading of the bikes.

In the intermediate and lowered positions it is necessary to use the licence plate holder bar with lighting group Licence Plate Carrier.

It can carry up to three bicycles in total safety. Available in two versions, anodised aluminium and black aluminium Deep Black, both versions have a stainless steel frame. Not suitable for vehicles with 270° hinge system. The installation requires the cutting of a small part of the bumper [3].

Available from March 1st, 2020.



Description	Ducato Frame >2006
Item No.	02094-25A [new]
Item No. Deep Black version	* 02094A25A [new]
Vehicle type	van conversion
Rear door	double door
Weight	21,0 kg
Max load	50 kg
Bikes carried standard	2
Bikes carried max	3
Bike-Block Pro S D1	● (x2) ○ (x1)
Security Strip	●
Rail Quick Pro	● (x2) ○ (x1)
Brackets	●
Licence Plate Carrier	○

● Standard ○ Optional

* For Deep Black version choose Bike-Block and additional rail in Deep Black version, see page 134/138

Standard rail support base

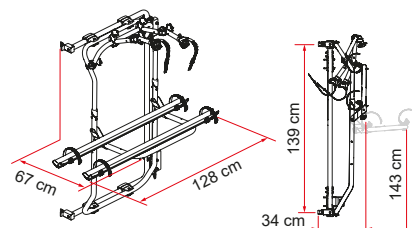

Midway rail support base

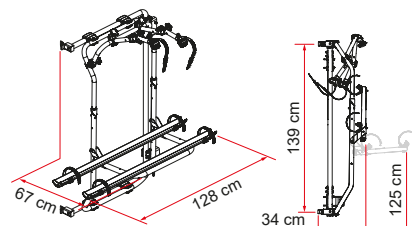

Lower rail support base

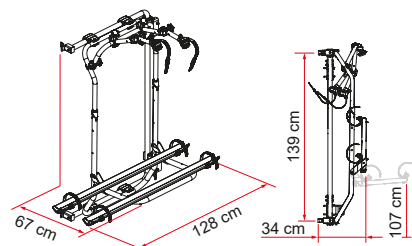

1 Solid stainless steel structure



2 Upper Fixing



3 Lower Fixing



Carry-Bike 200 DJ Ducato.

Restyling for the version >2006.

The new structure, thanks to the adoption of a single 35mm Ø aluminium tube, is light and modern, maintaining the solidity that has always distinguished this model.

The new structure guarantees a quicker and safer installation, also thanks to the new system of attachment of the main structure to the Fixing Bars.

The black colour of the plastics and covers is elegant and integrates perfectly with the vehicle.

This version allows the mounting of the rail support base in three positions, standard, intermediate and lowered to facilitate the loading of the bikes.

In the intermediate and lowered positions it is necessary to use the licence plate holder bar with lighting group Licence Plate Carrier (see page 141).

Two versions available: anodised aluminium and Deep Black version (in black aluminium).

Suitable for:

- Fiat Ducato after 2006 (H2 and H3)
- Citroën Jumper after 2006
- Peugeot Boxer after 2006



200 DJ
Ducato >2006



200 DJ
Ducato >2006
Deep Black

Standard
rail support
base

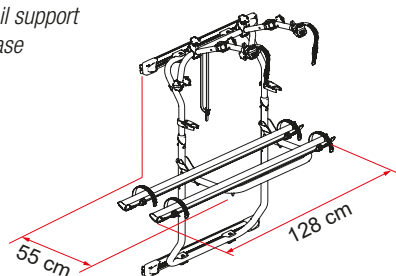

Midway
rail support
base

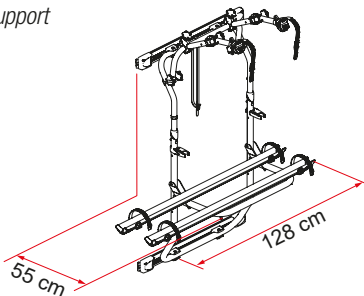

Lower
rail support
base

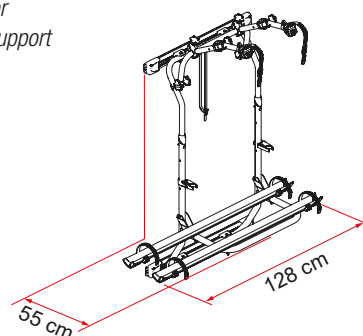



200 DJ SPRINTER / CRAFTER

- Mercedes Sprinter after 2006
- Volkswagen Crafter after 2006 before 2016

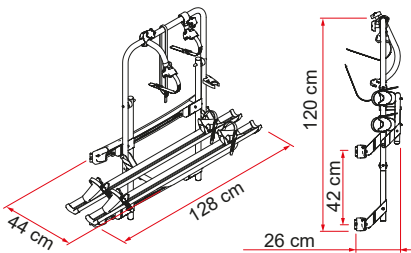

200 DJ DUCATO < 2006

- Fiat Ducato after 2000 before 2006
- Peugeot Boxer after 2000
- Citroën Jumper/Relay after 2000
- Mercedes Sprinter before 2006

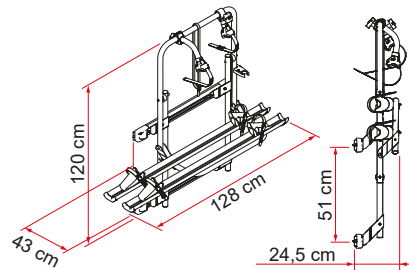

200 D

Bike carrier for van conversions with double rear doors, wheelbase variable from 58 to 62cm to adapt to different rear doors. Upper wall installation brackets only 34mm wide.

- Fiat Ducato and Peugeot J5 before 1999
- Ford Transit (H1, H2 and H3)
- Mercedes MB 100
- Peugeot Boxer and Citroën Jumper
- Citroën C25 before 1999
- VW LT (Standard and High Roof)

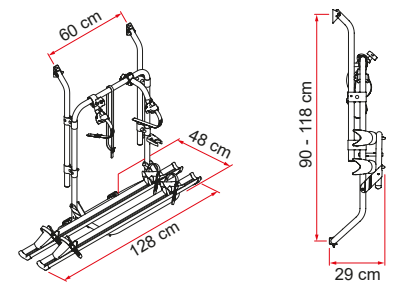

Description	200 DJ Ducato > 2006	200 DJ Sprinter / Crafter	200 DJ Ducato < 2006	200 D
Item No.	02094-26A [renewed]	02093B93A	02093A65A	02093A15A
Item No. Deep Black version	02094A26A [renewed]			
Vehicle type	van conversion	van conversion	van conversion	van conversion
Rear door	double door	double door	double door	double door
Weight	11 kg	9,0 kg	9,0 kg	6,9 kg
Max load	35 kg	35 kg	35 kg	35 kg
Bikes carried standard	2	2	2	2
Bikes carried max	2	2	2	2
Bike-Block Pro 1 (black)			●	●
Bike-Block Pro 2 (black)			●	●
Bike-Block Pro S D1	● (x2)			
Bike-Block Pro S 1		●		
Bike-Block Pro S 2		●		
Security Strip	●	●	●	●
Rail Quick Pro	● (x2)			
Rail Premium		● (x2)	● (x2)	● (x2)
Rail Premium S	○	○	○	○
Fixing-Bar	●	●	●	
Brackets	●	●	●	●

● Standard ○ Optional



CARRY-BIKE SUV



The bike carrier with universal straps for SUV and cars

The simple, rapid and safe solution to install a bike carrier on SUVs and 4x4.



BACKPACK

The Carry-Bike with universal straps is easily installed on all minivans.

Not suitable for fibreglass rear doors.

No tools are required for installation, 6 superior Heavy Duty Quick Lock straps secure the bike carrier to the vehicle.

Sturdy anodized aluminium tubes.

Stainless steel screws.

Consult your dealer to verify correct installation.

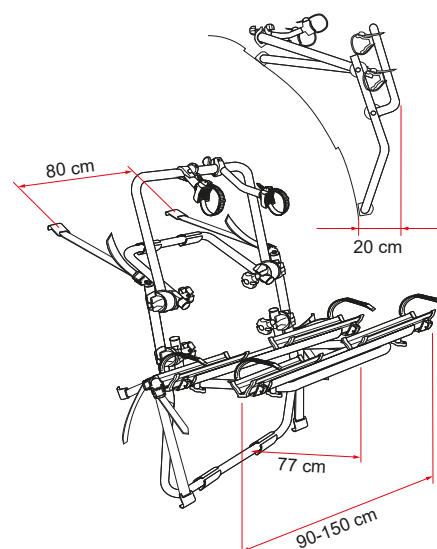



Choosing guide

Position

To be installed on the back wall of the vehicle with special straps.

Capacity

Two bikes carried as standard, up to 3 with extra Rail Quick C and additional Bike-Block for the model Backpack 4x4.

Rails

Two Rail C delivered as standard, which can carry any sort of bike and can also slide horizontally for easy positioning of the bikes.

Bike-Block Pro

Bike-Block Pro 1 and 3 (1 and 2 for the models 4x4) and 1 Security Strip delivered as standard.

BACKPACK 4x4

Bike carrier for SUV with rapid installation to the rear spare tyre thanks to the sturdy straps. Before mounting remove the rigid cover of the spare tyre.

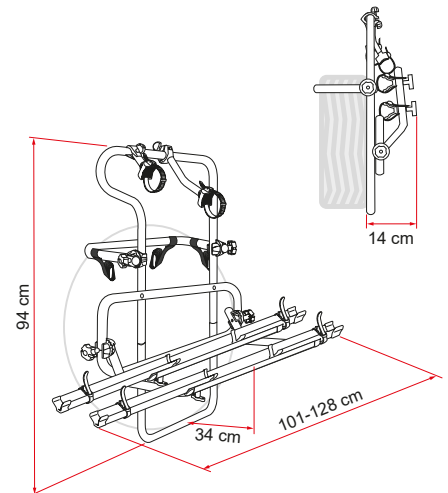

Description	Backpack	Backpack 4x4
Item No.	02093A38-	02093B38-
Vehicle type	SUV	SUV
Weight	8,0 kg	7,8 kg
Max load	50 kg	35 kg
Bikes carried standard	2	2
Bikes carried max	3	2
Bike-Block Pro 1 (black)	●	● (red)
Bike-Block Pro 2 (black)	○	● (red)
Bike-Block Pro 3 (black)	●	
Security Strip	●	●
Rail Quick C Black	● (x2) ○ (x1)	
Rail Strip C Red		● (x2)
Brackets	●	●

The use of licence plate carrier with control lighting is suggested (see page 141) in case the bike carrier covers lights and licence plate.

- Standard
- Optional



Bikes safe in the garage facility

Different models of bike carriers to install in the garage facility of your motorhome, in order to transport your bikes safely.

Various models available according to the number of bikes you wish to transport and the dimensions of your garage.



GARAGE PLUS

[1] Bike carrier for motorhomes with garage facility. Lower section can be folded up when not in use giving more floor space if required. With optional accessories carries up to 4 bikes.

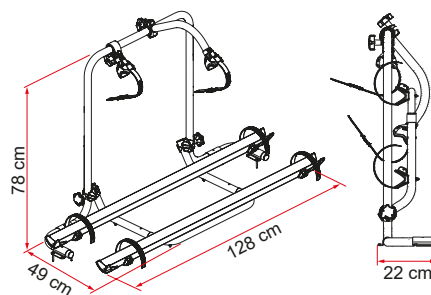

GARAGE STANDARD

[2] Bike carrier with lower section fastened to the floor and Bike-Block fixed to the wall or to the roof. Carries up to 3 bikes. Can be folded up when not in use giving more floor space if required.

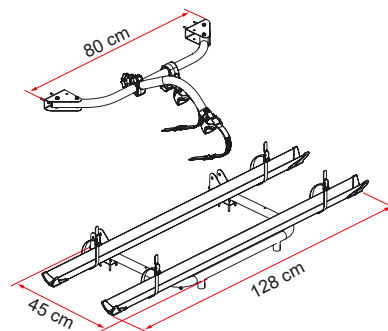



GARAGE SLIDE PRO BIKE

[3] Sliding bike carrier to install in the garage facility or storage compartment of the motorhome. Wide loading surface. Carries 2 bikes.

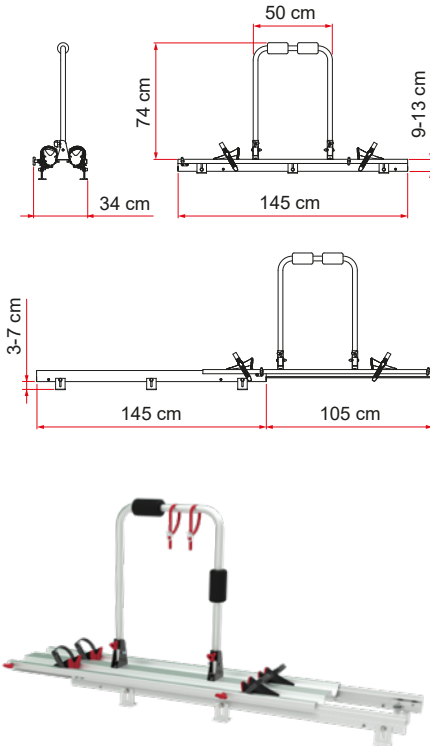

GARAGE PACK PLUS

[4] Multi-purpose kit complete with fixing structure for bikes and various accessories to arrange the garage facility in the best way.

Consists of:

- 2x aluminium bars 63cm
- 2x aluminium bars 198cm
- 2x aluminium bars 79cm
- 2x reinforced rails
- 1x support bar to fix Bike-Block
- 1x Bike-Block Pro D1 and Pro D2
- 1x Pack Organizer Shoes
- 1x Pack Organizer S
- 8x galvanized rings
- 1x rubber band Ø 0,8 x 180cm
- 4x Strip to fix bikes.



GARAGE PACK

[5] Multi-purpose kit to quickly and economically arrange the garage of your motorhome.

Simple and flexible modular system.

Consists of:

- 2x aluminium bars 63cm
- 1x aluminium bar 198cm
- 2x reinforced rails
- 2x galvanized rings
- 1x rubber band Ø 0,8 x 180cm.



Description	Garage Plus	Garage Standard	Garage Slide Pro Bike	Garage Pack Plus	Garage Pack
Item No.	02093A78A [renewed]	02093A54A [renewed]	04822-05-	98655A911 [renewed]	98655A910 [renewed]
Vehicle type	motorhome	motorhome	motorhome	motorhome	motorhome
Weight	5,6 kg	4,8 kg	9,9 kg	10,5 kg	4,0 kg
Max load	60 kg	50 kg	50 kg		
Bikes carried standard	2	2	2	2	2
Bikes carried max	4	3	2	3	3
Strip			● (x2)		
Bike-Block Pro 1 (black)	●	●			
Bike-Block Pro 2 (black)	○	○			
Bike-Block Pro 3 (black)	●	●			
Bike-Block Pro 4 (black)	○				
Bike-Block Pro D1				●	
Bike-Block Pro D2				●	
Security Strip	●				
Rail Strip Pro		● (x2) ○ (x1)		●	●
Rail Quick Pro	● (x2) ○ (x2)	○		○	○
Rail Premium XL	○	○		○	○
Rail Premium	○				
Brackets	●	●	●	●	●

● Standard ○ Optional



The moto carrier range for the garage facility of your motorhome

Different moto carrier systems, ideal to be installed in motorhomes with garage facilities. Some models are suitable for minivans or for the door of the motorhome. We suggest to always verify the usable height of your garage before purchasing the product.

CARRY-MOTO

Motor-bike carrier in galvanized aluminium consisting of a rail and a chute which slides in easily, to connect with the rail to facilitate the loading of the motorbike. Supplied with 2 sturdy straps to fix the motorbike while travelling.

CARRY-MOTO PRO

[1] Carry-Moto system in galvanized aluminium composed of 2 telescopic rails equipped with anti-slip device. It can easily be fixed inside the garage thanks to the fixing feet which are adjustable in height from 8cm to 11 cm. Consists of a rail fixed on the floor of the garage and a chute which slides easily inside the fixed rail. The rail is supplied with 2 straps to fix the motorbike while travelling.

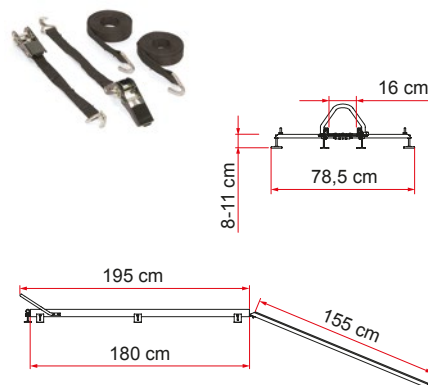
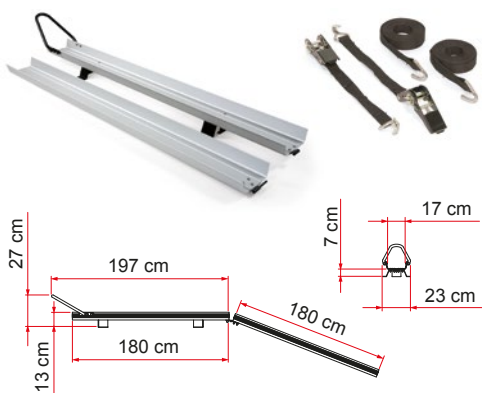



CARRY-RAMP

Motorbike ramp in galvanized aluminium that can be installed in the doorway of your motorhome or on the floor of the garage facility. Once the fixed plate is installed on the floor the ramp can be easily hooked and unhooked.

The rail can reach a length of 175cm through the telescopic slide. With 2 pieces of Carry-Ramp you can create a system of ramps for loading scooters and wheelchairs.

The 2 ramps hold up to 130kg, do not load wheelchairs when occupied.

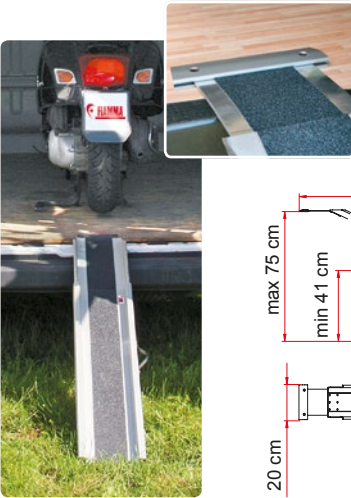

MOTO WHEEL CHOCK

The wheel chock for your motorbike is the ideal complement for the Carry-Ramp. Made of painted black steel.

Moto Wheel Chock Front: easy to assemble and remove thanks to the 4 screw anchor holes. Complete with kit for fixing to wood floors and two click strips.

Moto Wheel Chock Rear: easy to assemble and to remove thanks to the quick removable knobs.

Delivered as standard with rails for floor fixing.



Front



Rear

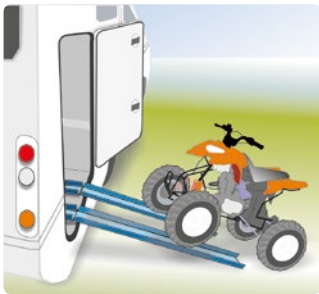
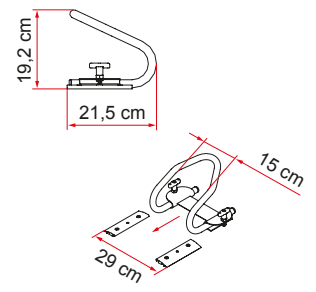
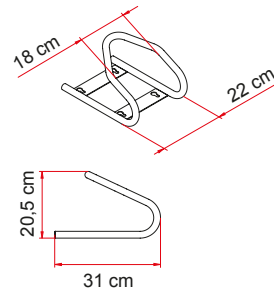

Two pieces together of Carry-Ramp to load Quads, wheelchairs or scooters

Description	Carry-Moto	Carry-Moto Pro	Carry-Ramp	Moto Wheel Chock Front	Moto Wheel Chock Rear
Item No.	02095-01-	02095-03-	02095-04-	05781-01-	05800-01-
Vehicle type	motorhome van conversion	motorhome van conversion	motorhome van conversion	motorhome van conversion	motorhome van conversion
Weight	12,2 kg	15,4 kg	7 kg	2,4 kg	2,8 kg
Max load	200 kg	200 kg	130 kg	---	---
Telescopic		●	●		
Ramp angle	variable	variable	fixed 25°		
Wheel chock front	●	●	○		
Wheel chock rear			○		
Fastening straps	●	●			
Wheel width max	14 cm	16 cm	15 cm	18 cm	15 cm

● Standard ○ Optional



Rails for transporting and fixing any kind of bike

Different types of rails available for transporting any kind of bike.

They are easily installed on bike carriers of any brand and fit most diameters of wheels on the market.

The load on Fiamma bike carriers must be distributed evenly over each of the rails, eg. a Carry Bike Pro rack if carrying 60kg of weight should have 15kg weight on each of the four rails.

RAIL QUICK PRO

[1] The original sturdy rail with a reinforced base delivered with two standard Quick-Safe sliding straps.

Easy to install on the Carry-Bike thanks to the pre-drilled holes on the rail support base.

Rail Quick Pro is interchangeable with the previous Rail Quick version.

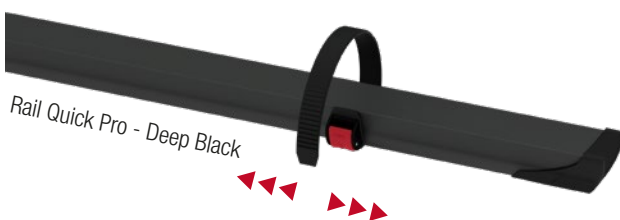
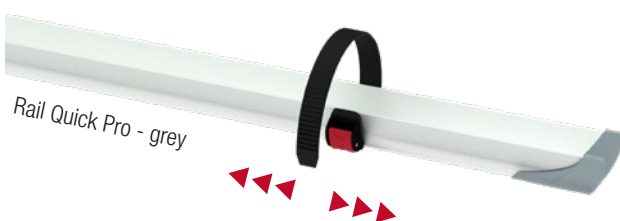
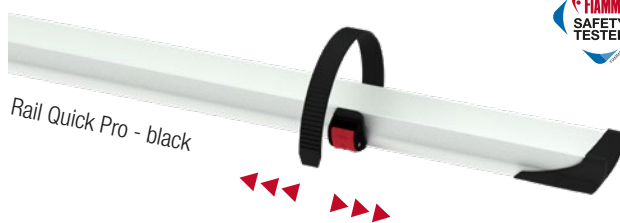
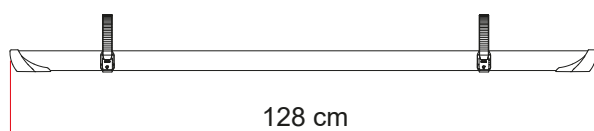

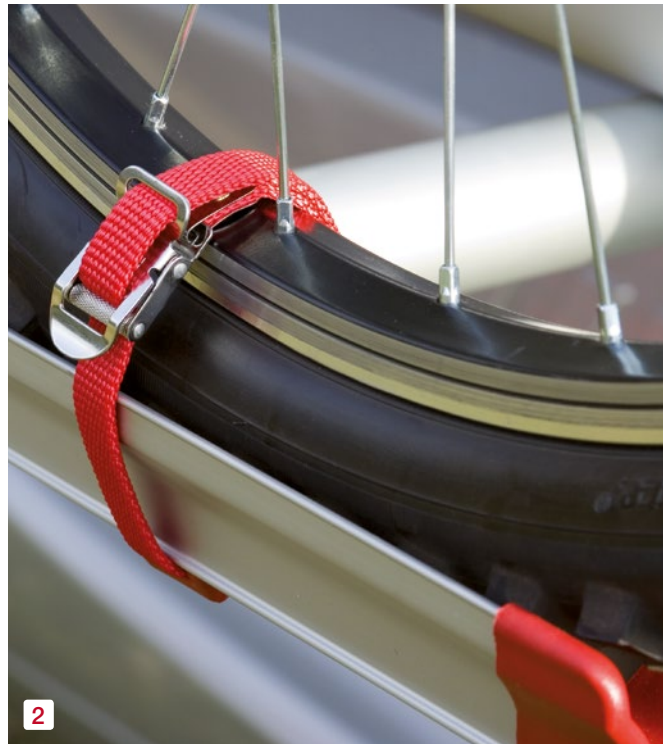

RAIL STRIP PRO

[2] The sturdy rail with a reinforced base and two sliding straps. Easy to install on the Carry-Bike thanks to the pre-drilled holes on the rail support base. Rail Strip Pro is interchangeable with the previous model Rail Strip.

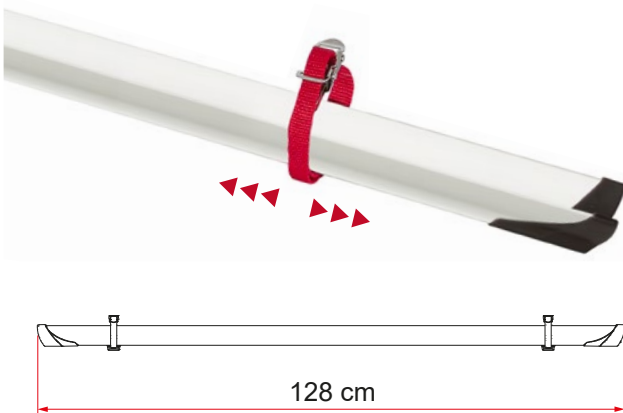

RAIL QUICK C

[3] Telescopic rail that can be adjusted to the desired extension, supplied with two Quick-Safe straps. Ideal to limit rail overhang. It can easily be installed on almost all bike carriers.

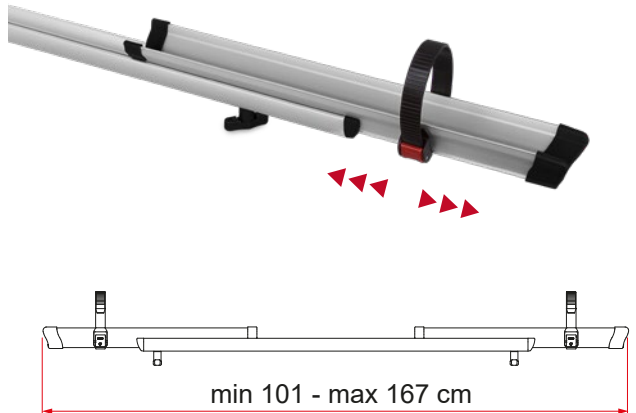

Description	Colour	Hooking type	Left-Right sliding	Back-Forward sliding	Length	Weight	Item No.
[1] Rail Quick Pro	black	Quick Safe	●	○	128 cm	1,0 kg	98656-993
[1] Rail Quick Pro [new]	blue	Quick Safe	●	○	128 cm	1,0 kg	98656M040
[1] Rail Quick Pro [new]	grey	Quick Safe	●	○	128 cm	1,0 kg	98656M289
[1] Rail Quick Pro Deep Black [new]	black	Quick Safe	●	○	128 cm	1,0 kg	98656M358
[2] Rail Strip Pro [new]	black	Strip	●	○	128 cm	1,0 kg	98656M288
[3] Rail Quick C [new]	black	Quick Safe	●	○	101-167 cm	1,2 kg	98656-369

● Standard ○ Optional

Rail

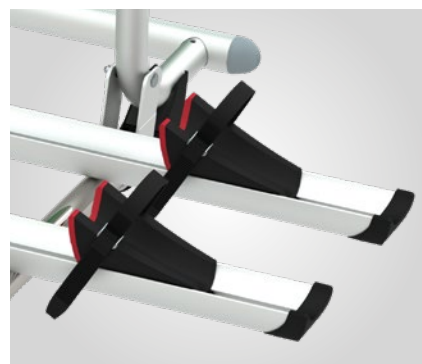

Refreshed design of the Premium Rail guide with new bicycle support block

If you wish to transport electric bikes, Fiamma recommends that you choose the Carry-Bike models specifically designed and developed for E-Bikes (see page 100-101) fitted with Rail Premium.

It is possible to transport a maximum of 2 electric bicycles on a Carry-Bike, we also recommend that the Rail Premium are placed close to the wall of the vehicle, and we suggest removing the batteries of the electric bikes for to limit the weight on the wall itself.

RAIL PREMIUM

[1] The restyling of the product has made it even easier and more practical to use. We have eliminated the adjustment and fastening handwheel. Just place the bicycle wheel in the strap and in combination with the rubber support, it will securely lock the bicycle on the rail.

RAIL PREMIUM XL

[2] The XL version is longer (139cm) and suited for particularly long E-Bikes and Mountain-Bikes (with wheelbase > 125cm).

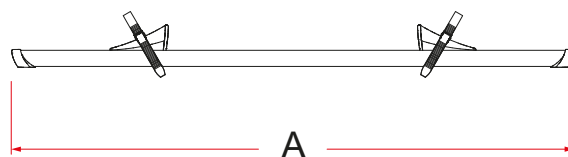

Rail Premium / XL

The 31cm strap is suitable for all bikes on the market

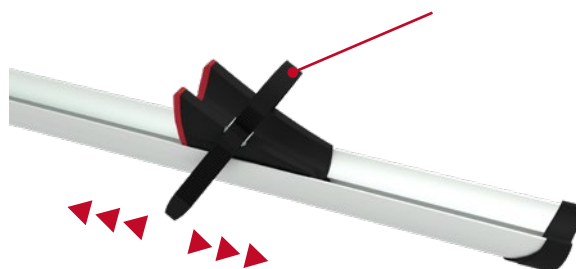

Rail Premium / XL Deep Black

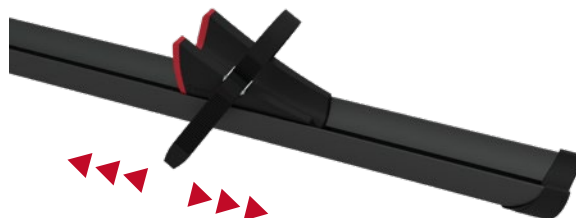



RAIL PREMIUM S

[3] Rail with increased structure size. The Premium S is similar to the Rail Premium but is also equipped with lower slide clamps that move in both directions, enabling you to easily secure the bike rails in the optimal position.

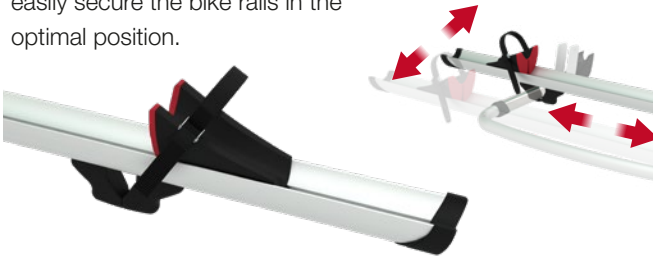

KIT PREMIUM S

[5] Allows to convert Rail Quick and Rail Premium into Rail Premium S. You simply have to unmount the standard hooks and replace them with Premium S hooks. Now rails can slide vertically and horizontally to be adapted to the dimensions of different bikes.



RAIL PREMIUM S FAT BIKE

[4] New model based on Rail Premium S version for transporting modern bicycles with tyres up to 5-inches wide on Fiamma bicycle carriers.



KIT RAIL PREMIUM 48

[6] Optional fourth two-part rail for Carry-Bike VW T5 Pro and T6 Pro models. Also available in the Deep Black version.



Kit Upgrade E-Bike

To carry your electrical bicycles on your Carry-Bike Pro, Pro M or Pro C

[7] Now you can turn your Carry-Bike Pro, Pro M, Pro C into a E-Bike bike carrier by purchasing the new Kit Upgrade E-Bike. Complete rail support base with two Rail Premium, structurally designed to carry two electric bicycles.



Description	Colour	Hooking type	Left-Right sliding	Back-Forward sliding	Length A	Weight	Item No.
[1] Rail Premium	black	Premium Quick	●	○	128 cm	1,3 kg	98656M131
[1] Rail Premium Deep Black	black	Premium Quick	●	○	128 cm	1,3 kg	98656M150
[2] Rail Premium XL	black	Premium Quick	●	○	139 cm	1,9 kg	98656M132
[2] Rail Premium XL Deep Black	black	Premium Quick	●	○	139 cm	1,9 kg	98656M153
[3] Rail Premium S	black	Premium Quick	●	●	128 cm	1,7 kg	98656M133
[3] Rail Premium S Deep Black	black	Premium Quick	●	●	128 cm	1,7 kg	98656M152
[5] Kit Premium S	black					0,3 kg	98656M134
[4] Rail Premium S Fat Bike	black	Premium Quick	●	○	128 cm	2,0 kg	98656M146
[4] Rail Premium S Fat Bike Deep Black	black	Premium Quick	●	○	128 cm	2,0 kg	98656M151
[6] Kit Rail Premium 48	black	Premium Quick	●	○	101-167 cm	1,2 kg	98656M087
[6] Kit Rail Premium 48 Deep Black	black	Premium Quick	●	○	101-167 cm	1,2 kg	98656M147
[7] Kit Upgrade E-Bike	black	Premium Quick	●	○	128 cm	5,5 kg	98656M137

● Standard ○ Optional

Bike-Block Pro S

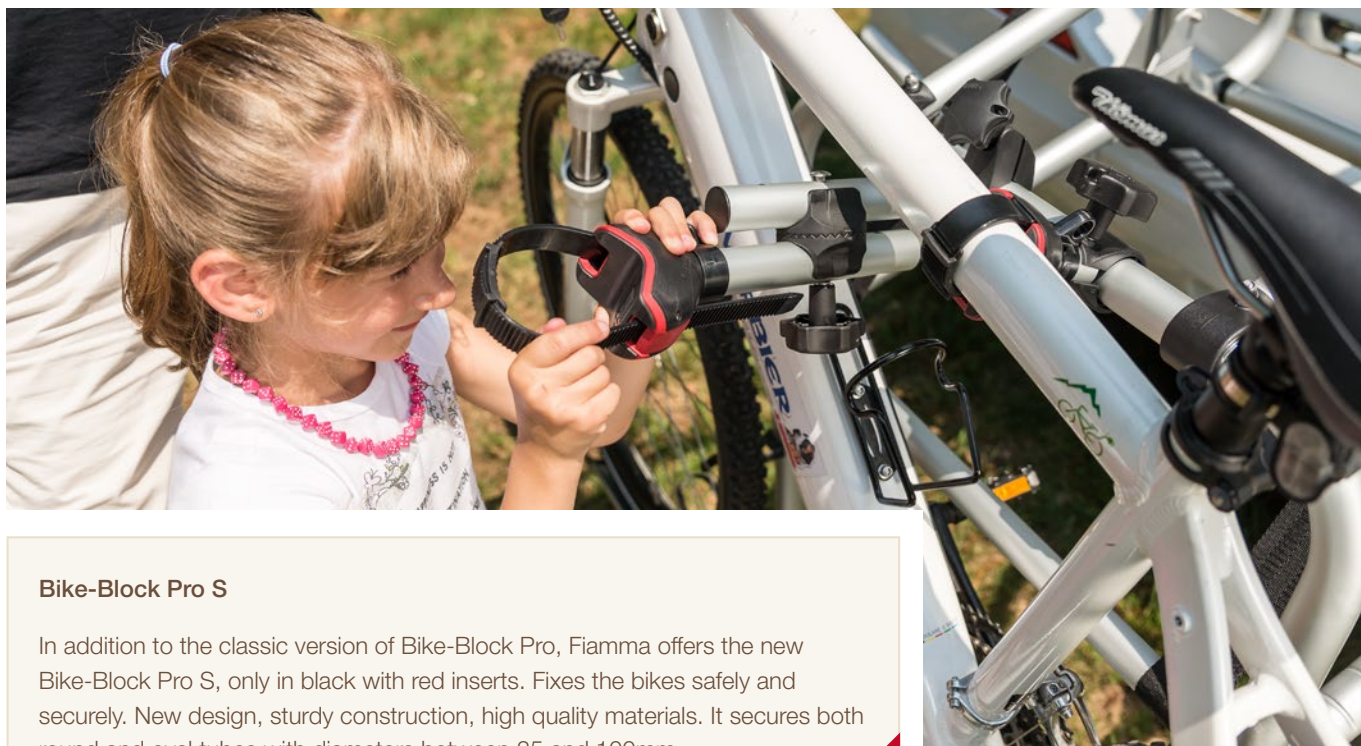

Bike-Block Pro S

In addition to the classic version of Bike-Block Pro, Fiamma offers the new Bike-Block Pro S, only in black with red inserts. Fixes the bikes safely and securely. New design, sturdy construction, high quality materials. It secures both round and oval tubes with diameters between 25 and 100mm.

Ergonomics and design synthesis

By changing the position of the knob that fixes the Bike-Block to the Carry-Bike we have allowed the free rotation of the clamp and of the bikes support.

The knob is now located at the front of the block, and the fixing of the anti-scratch rubber support has been improved to make it an example of design and convenience.



BIKE-BLOCK PRO S 1

min 12.5 cm - max 17 cm



BIKE-BLOCK PRO S 2

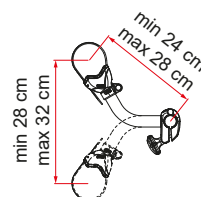

BIKE-BLOCK PRO S 3

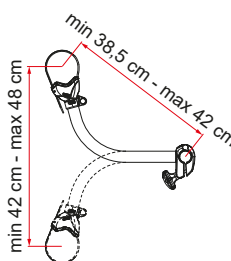

BIKE-BLOCK PRO S 4

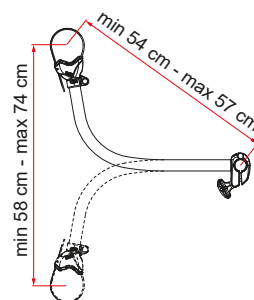

BIKE-BLOCK PRO S D1

min 10 cm - max 44.5 cm

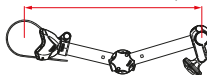

BIKE-BLOCK PRO S D2

min 16 cm - max 63 cm



BIKE-BLOCK PRO S D3

min 26 cm - max 79 cm

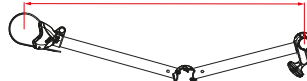

Description	Colour	Weight	Item No.
Bike-Block Pro S 1	black	0,2 kg	07215-01A
Bike-Block Pro S 2	black	0,3 kg	07215A01A
Bike-Block Pro S 3	black	0,4 kg	07215B01A
Bike-Block Pro S 4	black	0,5 kg	07215C01A
Bike-Block Pro S D1	black	0,6 kg	07215D01A
Bike-Block Pro S D1 *	black	0,6 kg	07215G01A
Bike-Block Pro S D2	black	0,7 kg	07215E01A
Bike-Block Pro S D2 *	black	0,7 kg	07215H01A
Bike-Block Pro S D3	black	0,8 kg	07215F01A
Bike-Block Pro S D3 *	black	0,8 kg	07215I01A

* Deep Black Version

Bike-Block Pro



The strongest, quickest and safest blocking system for bikes with new design

The Quick front clamp with its large non-scratch base fits round and oval bike tubes with diameters from 25mm to 100mm.

Suitable for all Carry-Bike models.

Bike-Block Pro D with articulated arm to cover all the medium sized Bike-Blocks.

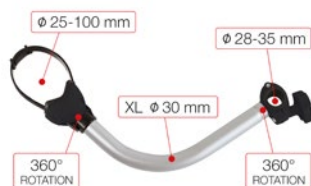

BIKE-BLOCK PRO 1

min 12,5 cm - max 17 cm



BIKE-BLOCK PRO 2

min 24 cm - max 28 cm



BIKE-BLOCK PRO 3

min 38,5 cm - max 42 cm

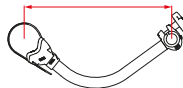

BIKE-BLOCK PRO 4

min 54 cm - max 57 cm

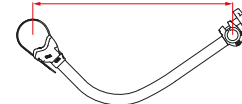

BIKE-BLOCK PRO D1

min 10 cm - max 44,5 cm

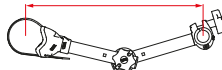

BIKE-BLOCK PRO D2

min 16 cm - max 63 cm



BIKE-BLOCK PRO D3

min 19 cm - max 81 cm

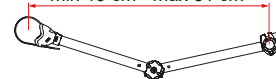

Description	Colour	Weight	Item No.
Bike-Block Pro 1*	black	0,2 kg	04133-01A
Bike-Block Pro 2*	black	0,3 kg	04133A01A
Bike-Block Pro 3*	black	0,4 kg	04133B01A
Bike-Block Pro 4*	black	0,5 kg	04133C01A
Bike-Block Pro D1 **	black	0,6 kg	04133E01A
Bike-Block Pro D2 **	black	0,7 kg	04133F01A
Bike-Block Pro D3	black	0,8 kg	04133G01A
Bike Frame Adapter		0,5 kg	06602-01-

* Available on request the red, blue and grey versions

** Available on request the red version

BIKE FRAME ADAPTER

Frame adapter for easy fitting to Bike-Block of bikes with non-standard frames, ladies' bikes and BMX's.

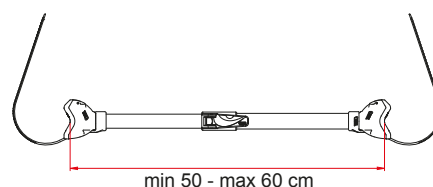

Locking System straps and anti-theft systems



QUICK-SAFE

[1] Sliding safety lock system. Can be installed only on original Carry-Bike reinforced rails. It grants a quick and safe locking of the wheel to the rail. Easy release for quick opening. 1 piece per packaging.



STRIP

[2] Kit of 2 original Strips with stainless steel buckle. Fits most bike carrier brands. Length 39cm. Width 1,3cm. 2 pieces per packaging.



SECURITY STRIP

[3] Original Strip, 200cm long, with stainless steel buckle. Fits most bike carrier brands. Width 1,3cm. 1 piece per packaging.



CABLE-LOCK

[4] Handy anti-theft cable made of black plastic-coated steel with incorporated padlock. Delivered as standard with 2 keys. Length 250cm. 1 piece per packaging.



Description	Weight	Item No.
[1] Quick-Safe	0,1 kg	98656-386
[2] Strip Red	0,1 kg	98656-320
[2] Strip Black	0,1 kg	98656-318
[3] Security Strip	0,1 kg	98656-419
[4] Cable-Lock	1,0 kg	98656-338



FIXING-BAR CARRY-BIKE

[1] Pair of reinforcement bars (240cm long) ideal for vehicles with rear walls that are not equipped with internal reinforced points.



LICENCE PLATE CARRIER

[3] Licence plate holder bar in aluminium with regulation lights. Ideal to be installed on Carry-Bikes with double rear doors, when the rail support covers the lights and the number plate of the vehicle; easy to install on the Carry-Bike's rail support with the brackets, which are delivered as standard. The bar turns 90° to be positioned correctly both on the open and closed rail support. Complete with 13 pole socket for rapid connection to the vehicle's electrics.

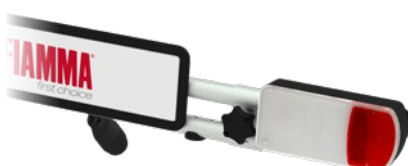
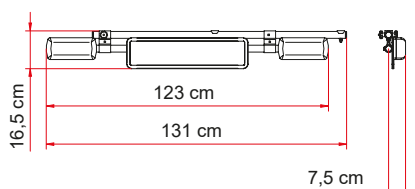

Licence Plate Carrier



Licence Plate Carrier Deep Black

Description	Weight	Lenght	Item No.
[1] Fixing-Bar Carry-Bike	5,5 kg	240 cm	98656-474
[2] Kit Support Bar	1,2 kg	74 cm	98656-682
[3] Licence Plate Carrier [renewed]	2,4 kg	131 cm	06146B01-
[3] Licence Plate Carrier Deep Black [new]	2,4 kg	131 cm	06146B01A
[4] Dust Guard	0,3 kg	240 cm	07752-01-

KIT SUPPORT BAR

[2] Kit of 2 preformed smart bars in anodized aluminium to fix the Carry-Bike on the walls of Motorhomes. Complete with through screws, internal fixing brackets and end caps for more flexibility of installation: the screws can slide over the bar to be adjusted to the different wheel bases.

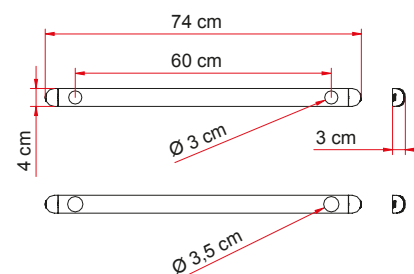
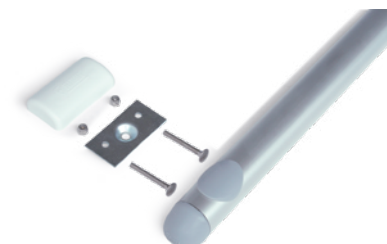

DUST GUARD

[4] Rubber guard for Fixing-Bar, Carry-Bike and Deluxe ladders. By completing the bar profile, Dust-Guard prevents accumulation of debris inside the bar improving the aesthetics.



Suitable for
Fixing Bar Carry-Bike
Carry-Bike 200 DJ Ducato > 2006
Carry-Bike 200 DJ Ducato < 2006
Carry-Bike 200 DJ Sprinter
Carry-Bike Mercedes Viano
Carry-Bike Ford Custom
Carry-Bike M. V Class Premium
Carry-Bike M. V Class Lift E-Bike
Deluxe DJ Ducato
Deluxe DJ Ducato H3
Deluxe DJ Sprinter

Signal plates for protruding loads



ALU SIGNAL

[1] Rear signal plate for protruding loads, fits easily to motorhomes, van conversions, campervans and 4-wheel drive vehicles.

Made of lightweight aluminium.
Dimensions: 50x50cm.

Compulsory in Italy.
Italian Ministry LL.PP has approved Fiamma Alu-Signal according to Sait D.M. N°937-29-03-94



PLASTIC SIGNAL

[2] Available also in lightweight plastic material with 4 reflectors.
Dimensions: 50x50cm.



Description	Weight	Item No.
[1] Alu Signal	0,7 kg	98782-010
[2] Plastic Signal	0,2 kg	98782-005

Bike Cover

renewed



Bike Cover Fiamma

New colours for the series of Carry-Bike covers, made in polyester reinforced resin, light, water-proof material. Enlarged dimensions to better cater for newer style bikes, for Bike Cover S (2/3 bikes and 4 bikes).

BIKE COVER S

[1] It adapts to any size load thanks to its adjustable straps.

Delivered as standard with transparent pocket to insert the rear signal plate.

BIKE COVER PREMIUM S

[2] Same features as the Bike Cover S but with self-lubricating side zippers and velcro, forms a complete enclosure around the bikes.

For a correct installation, you must place it before bicycles.

BIKE COVER CARAVAN

[3] With K-Way system, special version to cover bikes on Carry-Bike Caravan XL A, XL A PRO / E-Bike and Active / E-Bike.



Description	Bikes covered	Vehicle type	Closing system	Weight	Item No.
[1] Bike Cover S (2/3 bikes) * [renewed + enlarged dimensions]	2 / 3	Motorhome	Elastic band with hooks	0,9 kg	08208-01-
[1] Bike Cover S (4 bikes) * [renewed + enlarged dimensions]	4	Motorhome	Elastic band with hooks	1,0 kg	08208A01-
[2] Bike Cover Premium S * [renewed]	4	Motorhome	Zippers	0,9 kg	08208B01-
[3] Bike Cover Caravan [renewed]	2	Caravan	Elastic band with lock	0,8 kg	08208C01-

* Not suitable for bike racks where the bikes are exposed over the top of the roof



The most spacious rear boxes for Carry-Bike

The rear boxes are made with a top quality ABS-PLUS to provide high resistance against impacts and weather conditions as well as protection against ultra violet rays. They are co-extruded with extra thickness to prevent deterioration and are supplied with stainless steel hinges and aluminium profiles. Delivered as standard with flexible net to secure the transported items and with brackets for installation on the Carry-Bike.

ULTRA-BOX 320

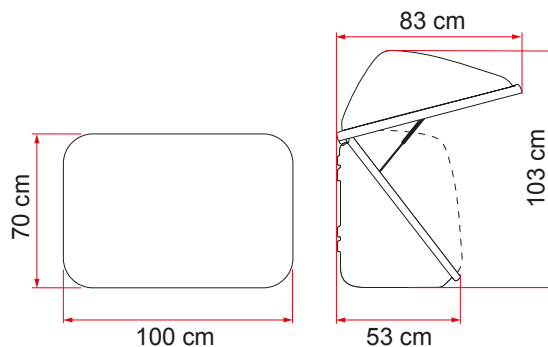

ULTRA-BOX 360

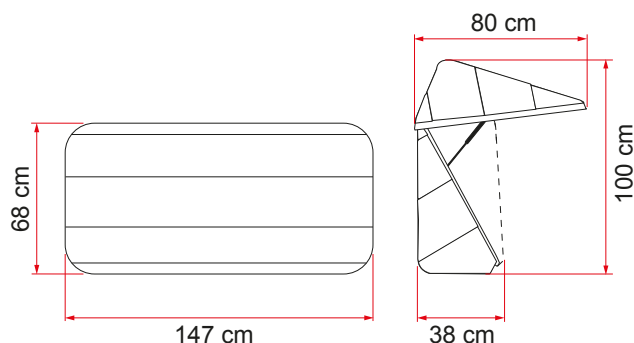

ULTRA-BOX 500

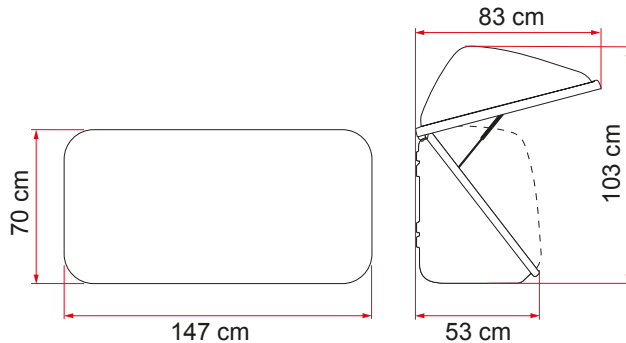

Description	Volume	External dimensions	Internal dimensions	Weight	Item No.
Ultra-Box 320	320 l	100x53x70 cm	88,5x46x62 cm	12 kg	04147-01-
Ultra-Box 360	360 l	147x38x70 cm	133,5x30x58 cm	14 kg	02801-01-
Ultra-Box 500	500 l	147x53x70 cm	133,5x46x62 cm	17 kg	04148-01-

Not suitable for Carry-Bike with offset rails

rear boxes and drying rack



EASY DRY

Drying rack adaptable to rail supports of most bike carriers

[3] Quick installation on the folding rail support base of all bikes carriers with Ø 35mm. tube. No drilling is required on carry-bikes with wheelbase 60-80cm.

The final parts of the Easy Dry are hooked to the tube of the rail support and then the drying rack is quickly ready to be used. You can even travel with your Easy Dry fixed on, thanks to its innovative folding structure.

Comes complete with plasticized ropes for hanging clothes and with adjusting handles.

Made of resistant light tubular anodized aluminium Ø 22mm.

Adjustable length:

- from min. 100 to max 120cm.

Width:

- open 60cm.
- closed 37cm.

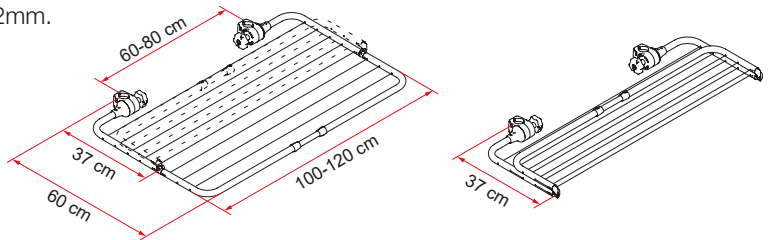

CARGO BACK

renewed

[1] New and modern restyling of the colours for the convenient soft luggage bag, made of solid, tear-resistant and waterproof polyester that can easily be installed on all rear bike carriers. Ideal for transporting chairs, camping equipment or sporting goods. Quick attach and remove system. Water resistant thanks to the YKK zippers. Fixing straps included.

Dimensions:

- Open 120x70x35 cm.
- Closed 38x28x10 cm.

KIT FRAME CARGO BACK

[2] The ideal system to keep your Cargo Back sturdy also when it's not completely full. Made of light anodized aluminium tubes and plastic connector pieces to be assembled together for a solid fastening.

This is a removable kit, easy to assemble and easy to fit inside your Cargo Back.

Dimensions:

- Open 119x69x32 cm.
- Closed 69x17x7 cm.



Description	Volume	Dimensions	Weight	Item No.
Cargo Back * [renewed]	285 l	120x70x35 cm	1,4 kg	08205-01-
Kit Frame Cargo Back		119x69x32 cm	1,2 kg	06106-01-
Easy Dry		100x60 cm	1,2 kg	06306-01-

* Not suitable for Carry-Bike with offset rails

FAQ - Frequently Asked Questions

Q - Do you have Fiamma dealers in my area?

A - To find your nearest Fiamma dealer, visit our web page "points of sales" on fiamma.com site.

Q - Can I purchase Fiamma accessories directly from Fiamma?

A - No, you can't buy directly from Fiamma. However you can easily place an order to your nearest Fiamma dealer (click on "points of sale" on our web site fiamma.com).

Q - Can I purchase Fiamma spare-parts directly from Fiamma?

A - To buy Fiamma spare parts please address your request to your reliable dealer.

Q - Can I bring my products to Fiamma to get them repaired?

A - No, we don't have a public service point but we suggest you to apply to a Fiamma dealer listed on "points of sales" on fiamma.com.

Q - How long does Fiamma warranty last and how does it work?

A - The warranty on Fiamma products lasts 2 years. It is necessary to have the relevant invoice/receipt of your product when visiting your dealer.

Q- What information must I provide to the service point to order spare parts?

A - The model of the product and its serial number (for awnings and Carry-Bikes), a copy of the relevant proof of purchase if the product is under warranty.

Q - Where is the S/N (Serial Number) of the awning?

A - The S/N of the awnings is on the internal side of the leadbar (F35/CaravanStore) or on the right arm (F45/F80/F65/Eagle); in order to read it you must open the awning.

Q - What awning can I install on my vehicle?

A - The choice of the awning depends on several factors: type of vehicle (motorhome, caravan, van), and type of structure. Our catalogue provides useful information to understand which is the suitable product for you. For specific information we always recommend that you consult your dealer.

Q - What is the difference between F45/F70 and F80/F65?

A - The fundamental difference between these two models is that F45/F70 is suitable for installation on the wall of the vehicle while the F80/F65 on the roof of the vehicle. The choice must be made according to the shape of the vehicle; when possible (when the wall of the motorhome is flat and with no windows, etc.) is always better to choose an F45/F70.

Q - What is the difference between the F45/F70 awning and F35pro awning?

A - The F45 (like the F80/F65) awning is the top of our line, high technology, with automatic opening using a crank handle. The F35pro awning has a smaller case, is less expensive and lighter and the opening/closing operation is manual, rolling the fabric in and out by hand.

Q - Are the installation adapters standard delivered with my awning?

A - A standard set of adapters (Kit AS 110/120/400 o 400L) is delivered with every F45s, F70 and F45L awning. We also have many other adapter kits specially designed for specific vehicles. The F45 Eagle awnings are delivered with full length AS bracket. The CaravanStore and the F35pro can be installed in the caravan awning rail where possible, otherwise you can order separately specific adapters. The Fiamma F80/F65 awnings are always supplied without adapters as the mounting system is different depending on what type of vehicle you have, so you have to order the installation brackets separately.

Q - Can I equip my Fiamma awning with a 12V motor afterwards?

A - Only the F45s, F45L and F80/F65 can be equipped with a 12V motor afterwards. CaravanStore and F35pro can not be motorized.

Q - Do Fiamma awnings always include a central rafter?

A - Not always. All F45 and F80/F65 awnings from 4.00m length are standard delivered with central tension rafter with the exception of the Eagle versions. One Rafter CaravanStore (Item No. 03888-01-) is standard included in the CaravanStore 4.10m and 1 Rafter + 1 CaravanStore Support Leg in CaravanStore 4.40m. In all other awning lengths the Rafter must be acquired as an optional accessory.

Q - Does my awning have support legs?

A - Yes. Support legs are included in all our awnings from 2.00m lengths onward. They are attached permanently to the awning and fold up inside the case when the awning is closed. Our Eagle awnings are self supporting and do not include support legs.

Q - What is the difference between fixing the support legs on the floor or on wall (using the appropriate brackets supplied as standard)?

A - It is always necessary to use support legs when opening an awning. The only exceptions are the Eagle models, which, not having the legs, are equipped with reinforced arms and structure. Fixing the legs to the ground, with the proper pegs, or on the wall of the vehicle with the suitable brackets, are both correct methods of operation.

Q - For the Fiamma ZIP and CaravanStore ZIP can I buy the awning and the enclosure separately?

A - No, ZIP versions are sold only complete. However, in special cases, you can require only the awning or only the complete closure (frontal + side panels) by replacing the complete closure of a damaged product.

Q - What can be used to clean my awning fabric?

A - The best way to clean it is to use water with a cloth or a soft brush. If it is very dirty, add some degreasing detergent to the water. Make sure to rinse carefully any remaining detergent on the fabric.

Q - How far can I extend the awning?

A - You can unroll the awning stopping at any distance you prefer. When the awning is fully extended, the fabric can sag lightly, just roll it back for about one turn to put it in tension again.

Q - Can I use my awning to protect me from the rain?

A - The awning is meant to shelter you from the sun and moderate rain. Therefore, we recommend you close the awning in case of strong wind, heavy rain or snow. For moderate rain use the central rafter and lower one leg to allow water running off. Water pooling can stretch the fabric causing faulty closing. Be careful because the fabrics with this kind of problem are not covered by warranty.

Q - Can I drive when my CaravanStore is mounted?

A - For small and longer distances, you can leave the CaravanStore mounted on the vehicle. Please consider that the vibrations can make the awning beat against the wall of the vehicle, causing noise and damaging the wall of the vehicle. Always check with the manufacturer of your caravan/motorhome.

Q - On which awnings can the Privacy Room be installed?

A - Privacy Room is designed for F45s, F45L F45 Ti, F45 Ti L, F45i and F45i L awnings. F80/F65 only if installed on Fiat Ducato after 06/2006 and on Caravan.

The Privacy Room cannot be fitted on models produced before the F45 Plus and Elegance.

The Kit Privacy O (which is standard delivered with the Privacy Room) allows the installation of the Privacy Room on Omnistor 5002, 5003, 4900 and Tristor2 awnings too.

FAQ - Frequently Asked Questions

Q - Can I install the Privacy Room for F45 on a motorhome with an F80/F65 mounted?

A - Normally no, but there are rare cases in which it is possible.

Q - Is the Privacy Room a tent awning?

A - No, the Privacy Room is not a tent and it needs to be mounted on an awning. The Privacy Room offers you extra space and also the possibility to sleep in it when the weather is nice. Please note that the Privacy Room is not a permanent tent and needs to be closed in case of storm and wind.

Q - Can the Privacy Room be used in Winter when snowing?

A - No, it is certainly not suitable. Even a thin layer of snow causes a heavy weight on the awning. This can lead to serious damage.

Q - Is the installation kit standard delivered with the Privacy Room?

A - Yes, the installation system is standard delivered with the Privacy Room (panels+aluminium structure), together with the Mega Bag (Large strong bag, suitable for transporting goods in the storage compartment or the Privacy during travelling).

Q - Is there a side or front panel that I can use on my awning?

A - Yes, as an alternative to the enclosures (Privacy Room), Fiamma offers front (Blocker) and side panels (Side) in different versions and lengths.

Q - Can I mount Side and Blocker panels on my awning?

A - There are many models for winch awnings (F45, F70, F80/F65) and for manual awnings (CaravanStore, F35pro).

Q - Which Carry-Bike can I install on my vehicle?

A - The choice of the Carry-Bike depends on the type of vehicle (motorhome, caravan, van) and on its structure. You can find a wide range of information on this catalogue. For further information and for professional support, we suggest to consult your dealer.

Q - Is the rear wall of my vehicle strong enough to install a Carry-Bike?

A - Most of the vehicles don't show any problem when mounting a Fiamma Carry-Bike, but we suggest for you to contact the dealer or the manufacturer of your vehicle in order to locate the most suitable installation points on the back of your vehicle (as they differ depending on the manufacturer).

Q - Can I carry electric Bikes on the Carry-Bike?

A - The Carry-Bike Lift 77, Pro and Pro C E-Bikes, Caravan XL A Pro 200 and Active E-Bike, Mercedes V Class Lift E-Bike and the models for the garage facility are ideal for transporting electric bikes, possibly with the addition of the optional Rail Premium E-Bike.

We suggest you place the Rails Premium E-Bike near the wall of the vehicle and for you to remove the batteries of electric bikes so as to limit the weight on the wall.

In accordance with the capacity of the Carry-Bike, a maximum of 2 E-bike rails can be used, each can carry up to 30 kg.

Q - Can I carry my motorcycle on the Carry-Bike?

A - Absolutely not. Fiamma Carry-Bikes have been designed for the exclusive transport of bicycles. Even if your motorcycle doesn't exceed the maximum load of the Carry-Bike, this value is calculated to uniformly distribute the weight on the structure; an excessive weight, like that of a scooter, localized on a single rail, is not allowed.

Q - What is the maximum speed I can travel with the carry-bike mounted?

A - With a Fiamma Carry-Bike mounted on the vehicle you can't exceed the maximum speed of 110 km/h (for minivans) and 90 km/h for motorhomes, even if you carry only one bike.

Q - Can the plastic signal for protruding loads (Plastic Signal Item No. 98782-005) be used in Italy?

A - Unfortunately a Plastic Signal is not approved in Italy and therefore it does not meet the requirements of the law. The Alu Signal (aluminium) is approved by the Italian Ministry of Transport and is therefore suitable.

Q - In the box of my Garage product I can't find the screws for the fixing to the floor / wall of the garage?

A - Most of the products for garage facilities, including the Carry-Bike, are supplied without screws for fixing on walls or on the floor of the garage because their structure (thickness, materials, etc.) varies greatly depending on the model. For more information, please refer to the installation manual attached to the product.

Q -The roof of my vehicle has a thickness higher than 5 cm. Is there a way to install the Turbo-Vent?

A - Yes, you can install the Turbo-Vent or the Vent thanks to a special extension (code 98683-116). However, the extension is not a cover, and then the portion of the cut roof will be visible through the rooflight.

Q - What Ultra-Box should I choose for my Carry-Bike?

A - All three Ultra-Box for Carry-Bike (320, 360, 500) can be mounted on all Fiamma Carry-Bike apart for the ones with the non-aligned rails, or not centred in the Carry-Bike (VW T5 D, VW T4 D, DJ 200, 200 D, Renault Traffic D). Be careful not to exceed the maximum capacity of the bike carrier, which has to be calculated adding the weight of the Ultra-Box to the weight of its contents.

Q - Can I travel with the rooflight open?

A - No, travelling with the rooflight open may damage it and it's dangerous for other motorists.

Q - What is the maximum distance I can have between the pump Aqua 8/F and services?

A - Fiamma pumps can bring the water at distances superior then the ones of any existing recreational vehicle.

Q - What is the maximum height Aqua 8/F pump can push the water?

A - Even in this case Fiamma pumps have a hydraulic performance that is superior to the needs of campers and motorhomes.

Q - What is the maximum water temperature for Aqua F and Aqua 8 pumps?

A - The water must be at room temperature. It can't be preheated with other devices.

Q - What versions of Safe Door and Security can I install on my vehicle?

A - There are no special constraints if there is enough space for the product on the external side, and for its bracket (or frames) on the inner side.

Q - Does Fiamma Super Kem and Super Rinse respect the environment?

A - Of course. Fiamma chemical products don't contain formaldehyde, comply with all national and international regulations respecting the environment.

A	
A20	163
Adapters CaravanStore	95
Adapters Compass	95
Adapters F35pro	93-95
Adapters F45 - F70	80-86
Adapters F40van	92
Adapters F80 - F65 - F65eagle	87-91
Alu Jacks	172
Alu Signal	142
Anti Slip Plate	171
Aqua F	162
Aqua 8	163
Awning Arms LED	158
B	
Bidet	195
Bike Cover Caravan	143
Bike Cover Premium S / Cover S	143
Bike Frame Adapter	139
Bike-Block Pro S / Pro	138-139
Bi-Pot	192-193
Blocker / Blocker Pro	44-45
C	
Cable-Lock	140
CaravanStore / XL	34-35
CaravanStore Support Leg	76
CaravanStore ZIP XL	62-63
Cargo Back	145
Cargo Strap	180
Carry-Bike 200 D	127
Carry-Bike 200 DJ	126-127
Carry-Bike Backpack / 4x4	128-129
Carry-Bike Caravan Active / E-Bike	112-113
Carry-Bike Caravan Hobby	114-115
Carry-Bike Caravan Universal	114-115
Carry-Bike Caravan XL A	112-113
Carry-Bike Caravan XL A Pro	113
Carry-Bike Caravan XL A Pro 200	113
Carry-Bike Caravan XL A Pro 200 / E-Bike	113
Carry-Bike CL	106-107
Carry-Bike Ducato Frame	125
Carry-Bike E-Bikes	102-103
Carry-Bike Ford Custom	122-123
Carry-Bike Ford Transit	123
Carry-Bike Garage Plus	130-131

Carry-Bike Garage Slide Pro Bike	131
Carry-Bike Garage Standard	130-131
Carry-Bike L80	111
Carry-Bike Lift 77 / E-Bike	108-109
Carry-Bike Mercedes Viano	120-121
Carry-Bike Mercedes Vito	120-121
Carry-Bike Mercedes V Class	120-121
Carry-Bike O. Vivaro / R. Trafic	122-123
Carry-Bike Pro / Pro C / Pro M	104-105
Carry-Bike Pro Autotrail	110-111
Carry-Bike Pro C Knaus	111
Carry-Bike Pro Hymer - Dethleffs	110-111
Carry-Bike Renault Trafic D	123
Carry-Bike Simple Plus 200	115
Carry-Bike Trigano - CI	111
Carry-Bike UL / UL 48	106-107
Carry-Bike VW Caddy	118-119
Carry-Bike VW Crafter Frame	124
Carry-Bike VW T2	119
Carry-Bike VW T3 (T25)	119
Carry-Bike VW T4 / T4 D	118-119
Carry-Bike VW T5 Pro / T5	116-117
Carry-Bike VW T6 Pro / T6	116-117
Carry-Bike VW T5 D / T6 D	118-119
Carry-Dog	176
Carry-Moto / Pro	132-133
Carry-Ramp	133
Chock Level	171
Clean Step	173
Compass	38-39
Cover Premium	196
Cover Top	196
Coverglas XL Ducato	197
Crank Handle	74
Curtains Kit Smoke	76
D	
Deluxe	186-188
Dispenser	195
Door Holder	199
Door Pole	75
Drip Stop	198
Duo-Safe Pro	183
Dust Guard	141
E	
Easy Dry	145

F	
F35pro	36-37
F40van	32-33
F45eagle	24
F45L	22-23
F45s	16-17
F45s VW T5/T6	18
F45s PSA	19
F65eagle	30-31
F65L	28-29
F70	20-21
F80s	26-27
Fiamma ZIP	60-61
Fix Organizer	174-175
Fixing-Bar Carry-Bike	141
Fixing-Bar Pro L	191
Fixing-Bar Rail	190-191
G	
Garage Bars	178
Garage Box	177
Garage Carry-Rail	179
Garage Pack / Plus	131
Garage System	177
Grip System	170
K	
Kit Adapter T5 to T6 / T5 pro to T6 pro	117
Kit Awning Hangers	73
Kit Awning LED	158
Kit Awning Pegs	70
Kit Awning Plate	70
Kit Cables Guide / Rail	158
Kit Dethleffs	110
Kit Eye	178
Kit Frame Cargo Back	145
Kit Garage Wall Brackets	177
Kit LED Awning Case 50	159
Kit LED Strip Awning / Brightness	158
Kit Level Up	168-169
Kit Level Up Jumbo	168-169
Kit Magic Privacy	75
Kit Poles	77
Kit Poles Light	76
Kit Premium S	137
Kit Rail Premium 48	137
Kit Rain Guard	78-79

Products alphabetic index

Kit Repair Plus	74
Kit Sanitary Flex	165
Kit Security Lock	184
Kit Spacer Security Fendt	184
Kit Square Plates	178
Kit Support Bar	141
Kit Turbo Vent 28 F	150
Kit Turbo Vent F / Premium / P3	151
Kit Upgrade E-Bike	137

L

LED Awning Case	159
LED Awning Light	160
LED Awning Light Gutter	161
LED Garage Light	160
LED Sensor Door Light	161
LED Step	161
LED Warning Solar	160
Level Bag / S	171
Level Plate	171
Level Pro	169
Level System Jumbo	169
Level System Magnum	169
Level Up	168-169
Level Up Premium	166-167
Licence Plate Carrier	141
Luggage Bar	179

M

Magicrafter / Pro	69
Mega Bag / Light	73
Moskito Net / Net Pro	198
Moskito Net Door	77
Moto Wheel Chock	133
Motor Kit	66-67
Mud Flap Front / Rear	198-199

O

Omni Stop	199
-----------	-----

P

Pack Organizer	174-175
Pack Organizer Privacy	77
Pack Waste	176

Patio-Bag	72
Patio-Mat	72
Plastic Jacks	172
Plastic Signal	142
Plates / Plates Pro	172
Pocket Kassett	194
Pocket M / L / XL	176
Privacy Rail Kit	76
Privacy Room	48-51
Privacy Room CS Light	58-59
Privacy Room Light	52-53
Privacy Ultra Light	54-55

Q

Quick Connection W	165
Quick-Safe	140

R

Rafter / Rafter CaravanStore	68
Rafter LED / CaravanStore	159
Rafter Pro	68
Rail Premium / S / XL	136-137
Rail Premium S Fat Bike	137
Rail Quick Pro / C	134-135
Rail Strip Pro	135
Rain Caps	79
Rain Guard	78-79
Rear Door Cover	64
Rear Skirting	65
Roller Roof Rail	191
Rollo Vent 40	155
Roll-Tank	164-165
Room van	56-57
Roof Rail / Ducato	191

S

Safe Door	182-183
Safe Door Guardian	181
Safe Ladder	186
Safety Strip	73
Security	184-185
Security Grip	184-185
Security Strip	140

Shade Sun View	45
Side W Pro	46-47
Side W Pro Shade	46-47
Side W Caravanstore	47
Skirting	65
Slide Out	25
Soft 6	195
Spoiler 40	155
Spoiler S	73
Spoiler Universal	155
Step / Step magnum	173
Step-Mat	173
Strip	140
Super Kem Blue	194
Super Kem Sachets	194
Super Rinse	194
Sun View Side	47
Sun View XL	45

T

Table Legs	199
Tank 70	164
Thermo Vent 40	155
Thermo Wall Ducato Cabin	197
Thermoglas XXL Ducato	197
Tie Down / Tie Down S	71
Toilet Brush / Pro	195
Turbo-Kit	149
Turbo-Vent	152-153
Turbo-Vent Premium	152-153

U

Ultra-Box 2/3	189
Ultra-Box 320-360-500	144

V

Vent	152-153
Vent F Pro	151
Vent 28 F	150
Vent 50	154

W

Water Cap	164
Wheel Saver	170



Awnings
Enclosures
Bike carriers

Rooflights **LED**

Pumps

Tanks

Organizer

Levellers

Garage Accessories

Luggage racks

Security



Fiamma SpA - Italy

Via S. Rocco, 56

21010 Cardano al Campo (VA)

Fax +39 0331 263 777